

A GUIDE TO  
KIDDERMINSTER  
AND NEIGHBOURHOOD;

TOGETHER WITH A

Directory

AND

SHORT HISTORY OF THE TOWN,

Its Commerce: Ancient and Modern—Obsolete Customs—  
Public Buildings—Statues—etc.

LIST OF DRIVES TO SURROUNDING PLACES OF INTEREST

AND

A LIST OF WALKS TO PLACES SELDOM VISITED.

Routes—Time taken—Distance and Expenses  
(*from a personal knowledge*).

Coaches and Coaching about Fifty years ago.

DESCRIPTION OF AN OLD HAND-LOOM AND A MODERN LOOM.

A few particulars about the Railway—Antiquities—  
Bombazine Weaving—Attempt to make the River Stour Navigable—  
Cab Fares from the Station—Omnibuses—etc.

Postal Information, Local and other matter.



By EDWARD BROADFIELD  
(*Postmaster*).

KIDDERMINSTER:

W. HEPWORTH, PRINTER AND PUBLISHER, BULL RING.

1889.

## Preface.

THE beautiful scenery and places of interest in and about Kidderminster have lately attracted attention. I have received several letters from various parts of the country asking if I could recommend a Guide-Book. There is no such book to be obtained. I consulted with some friends who all promised to assist me, but no one would take the trouble of compiling a Guide. I have taken it upon myself and thank those friends who have given so much valuable information. There are, no doubt, shortcomings, but I have done as well as I can to interest the reader.

E. BROADFIELD.

*Kidderminster,*

*November, 1838.*



## Kidderminster.

THE latitude is 52 deg. 25 m. North of the Equator ; longitude 2 deg. 15 m. West from Greenwich, 125 miles N.W. of London. The Parish Boundary is irregular in shape. The Severn, from Eymore Wood to Stourport, forms the Western Boundary ; the Bridgnorth road from Shatterford (or Shatterfoot) to Honey Brook the North-East Circuit, West of the Stour : about two miles and a half of the Stour-bridge road, a lane connecting it with the Birmingham road at Blakedown, drawn in a South-Westerly direction from Blakedown to Falling Sands, and the river Stour itself is the general outline on the East side.

*Geology.*—The first tract of land which appeared above the primeval waters was Trimpley ; next in antiquity comes Eymore, situate upon coal measures ; next most ancient portion is Warshill ; then Habberley valley and the country South of it. A most remarkable feature of the surface of this part of the country is the recurrence here and there of rounded knolls, so regularly formed as to appear artificial. The geological theory is that there was formerly a strait or arm of the sea extending all the way from the mouth of the Severn to that of the Dee, covering this part of the country ; that it ran up into Habberley valley and the valley of Broadwaters, and the substance of these hills being soft sandstone, they were washed by the action of the water into these forms.

The name is supposed by some to be a contraction of the name of Cynebert, a Saxon earl, who is thought to have been the founder of the Church ; and thus Cynebert's Minster has been thought to have become abbreviated into Kidderminster. Others have considered "Kidder" to be composed of two old British words : "Kid" signifying—The Brow of

a Hill; and "Dwr"—Water. According to this the name of our town would mean—A Church standing on the Brow of a Hill near Water; *i.e.*, the water of the Stour—a very appropriate name.

### The Town of Kidderminster.

The town is very irregularly laid out; all buildings erected of late years, particularly business premises, are good in every way, the latter being very handsome. There are some odd contrasts between these buildings and those erected in former days, notably in Worcester Street, Mill Street, and Bewdley Street, where, until a few years ago, people lived in rooms or holes cut in the solid rock; the place was called "The Battery." The names of some parts of the town are very odd, and in some cases ugly, thus: "Teakettle Alley," "Rabbit-cub Row," "Holland," "The Mouth of the Nile," "Cobbler's Corner," "Mud Island," "Magpie Row," "Tinker's Hill," "Tinker's Alley," "The Gob," "Jerusalem," "Gallows Lane," "Cursefield," "California," "Trafalgar," "Step Entry," and the "Daddle Brook," a very troublesome stream, now covered over. In winter it used to overflow and in summer to smell. It is only about three-quarters of a mile long, and the way it deviates to call on public houses is amazing. It rises at the back of St. George's Brewery, calls in at the "Shakespeare," takes a slight turn to see Messrs. Bucknall's Brewery, the "Britannia Inn," and "Black Star," then rambles to the "Fleece," calls on the "Black Bull" and "Fox," gets under the Bull Ring to have a run in at the "George and Dragon," and then joins the river Stour.

A.D.  
716  
to  
757

*Ancient History.*—Ethelbald, King of the South Angles, gave to Earl Cynebert ten cassats of land in the province of the Usmers upon both sides the river Stur (Stour), having Kinver Wood on the North and Moreheb Wood on the South, the greater part of which belongs to the said lands.

\* 1016 William the Conqueror holds in demesne Chideminstre, with sixteen Berewicks or corn farms (named), Wannerton, † 1154 Trimpley, Franche, Habberley, Sutton, &c. † Kidderminster continued the property of the crown till the time of Henry II. The King gave it to Manser De Biset, who held the office of Dapifer or Cupbearer to the King. It remained with the

family of Bisets till the end of the reign of Edward I. in 1307. This family was at last only represented by two co-heiresses. They divided. One, being a leper, she gave her moiety and the parsonage to the Hospital of Maiden Bradley, in Wiltshire, being a Lazarhouse for women. The names of Cokesey, Burnell, and the Prior of Maiden Bradley occur as holding lands at Kidderminster. Sir Nicholas Burnell, and his son Sir Edward were seized of one moiety of the Manor. The other moiety belonged to the Hospital of Maiden Bradley. † The Monasteries were suppressed, and this moiety was given to John Dudley, Viscount Lisle, who was beheaded for treason. § This moiety became the property of the Blounts of Kinlet, and remained till the death of Sir Edward, without issue, in 1630. Then, by deed to the Earl of Newport; then, by sale, to || Mr. Waller, the poet. Mr. || Waller sold part of his property in Kidderminster, including Hurcott and Comberton for £10,000 to pay a fine. Thomas Lord Foley purchased that part of the Parish and Manor which belonged to Lord Abergavenny. ¶ The bulk of the Foley property passed into the hands of the late Lord Ward, Earl of Dudley.

A.D.

† 1337

§ 1553

|| 1643

¶ 1838

*Carpet Manufacturing* was introduced into Kidderminster so lately as 1735, at which time the fabrics manufactured here chiefly consisted of Bombazine Frieze, Tammies and Ratteens, in 1755 Silks, Woollen Camlet, Glossanett, Poplin, and several kinds of Crape; but the new field of enterprise opened by the introduction of Carpets, drew from these branches of trade much capital and skill, till this has gradually become the staple article of manufacture, and is brought to greater perfection here than in any other part of the world. A model of an old hand-loom, the property of G. W. Grosvenor, Esq., may be seen at the School of Science and Art.

### Description of a Hand-Loom.

The original Hand-loom used in Kidderminster for the manufacture of Brussels carpets were brought over from Belgium (Brussels probably) by Mr. John Broom. The carpet masters employed, before *Jacquards* were introduced, an apparatus for producing the pattern, called, as a whole, the *mouture*, the manipulating portion of which was called

the *simple*; and the looms were called *simple looms*, to distinguish them from those having *Jacquards* or *engines*. The word *mounture* and several names of other parts of the loom, appear to be of foreign origin, but the word *simple*, which was often used to mean the *mounture*, may have arisen in Kidderminster. The *mounture* consisted of *tail*, *simple*, *neck*, and *harness*, all made of cordage; also a box or framework containing bowls or small pulleys with flanges, round which the *tail-cords* revolved in connection with the *neck* and *harness*. The box of bowls was fixed on the top of the loom framing; the *tail* went from the box horizontally some distance over the right hand of the loom; the *neck* and *harness* descended immediately from the box of bowls, and the simple cords were attached to the tail cords, just outside the right of the loom, and fastened to the ground at the bottom end. There were 1300 of these simple cords, and it was by grasping with the hand and drawing down selections of them that the desired colours were raised by the *neck* and *harness* for producing the pattern. These selections (which had 260 cords in each) were obtained by reading them in or off the design paper, and were separated and preserved from the mass by finer threads passed round them called *lashes*, so that they could be pulled apart for the purpose of being taken hold of and drawn down by the *draw-boy*. When the required worsted threads were thus raised up, the *draw-boy* passed underneath the *sword* (a long bat-like piece of wood), which, being turned up on edge, formed an opening or bosom for the insertion of the wire upon which the loops were formed, and bound by the weaver throwing the shuttle.

The other things and terms used about the Hand-loom were as follows:—*Rockatee-rod*, *tanto*, *lingoes*, *tumblers and lambs*, *treadles*, *gears or healds*, *false-simples*, *wire-hook*, *oil-brush and tin*, *have-a-sink*, *starch and quil*, and *dandy*.

The *rockatee-rod* was a rod similar to a yard measure, and was used to fasten the beginning end of a length of carpet to the wooden roll on which it was wound as it was woven; this was done by connecting it with the carpet end called *drop-lea* by cords, and then placing it in a groove of the said roll, and the carpet passing round it held it firmly in.

The *tanto* was an iron lever used to wind up the carpet on

the above roll, which required considerable force to accomplish.

The *lingoes* were long thin weights cut out of rod-iron, about a foot long, for each of the *harness cords*; sometimes they were made of lead. There were also bullets of iron or lead to each of the worsted bobbins.

The *tumblers and lambs* were wooden levers to which the gears were affixed to enable them to be raised and lowered by the weaver's tread on the treadles.

The *false-simple* was a contrivance for drawing off and preserving a pattern (that was done with) from the loom, by tying cords to the *simple* and intersecting it with cords across to correspond with each *lash*, and then disconnecting it and wrapping it round a stick, from which the pattern could be re-transferred to the loom at any time.

The *wire-hook*, to draw the wires out of the carpet after being woven in.

The *oil-brush and tin*, to lubricate the wires a little, so as to draw out easily.

The process of winding-up, or screwing-up, the carpet on the roll, was called *have-a-sink*.

To *starch* was to apply starch or size with brushes to the bottom chain, being the warp threads for making the back or canvas parts of the carpets.

To *quil* was to wind the weft thread on wooden spindles for the shuttles.

The *dandy* was what is now called the *stuffer*, and was an extra warp, which was also starched, and its purpose was to fill up and give stiffness to the back of the carpet.

### The Power=Loom.

For those who have not seen the process of weaving, they may form some idea of the construction of the fabric by comparing it to Berlin wool work, with a second canvas to cover the back and thus hide the crossings of the stitches; the two canvases and the stitches or loops which form the pattern being all woven at the same time. The canvas, like all other weavings, is formed by threads running length-ways,



intersected by cross threads from selvage to selvage, put in by the shuttle; the former are called the warp, and the latter the weft. The warp threads for the canvases are wound upon a kind of large bobbin, and the worsted threads for the pattern are each wound upon separate small bobbins. The former are passed through eyelets attached to perpendicular wires strung upon a frame-work, which has the capability of moving them up and down; there are two of these frames or gears, and when one is up the other is down, and thus a passage is opened between the alternate threads for the shuttle; and after two wefts are placed in a complete stitch is formed, and the process goes on continuously. The worsted threads are passed through eyelets in the *harness*, a mass of cords suspended from the *Jacquard*, which is fixed overhead; also for the purpose of raising and lowering the said worsted threads. All these threads are then passed through the reed (a comb-like instrument) which, having an equal number of threads placed between each of its teeth, keeps them in place, and moving to and fro, pushes up the weft after the shuttle has passed across. The bobbins, large and small, are weighted to keep the threads tight, and all the ends passed through the reeds are held with the carpet being woven by a roller covered with short spikes, which pulls the carpet forward as it is woven and delivers it in folds into a box below the loom.

The process of weaving is as follows:—The *Jacquard* selects the particular coloured worsted threads required to form a row of loops across the carpet by raising them up. A wire runs underneath them; they are then lowered, the shuttle flies across, putting in a weft, binding them down upon a wire, and, at the same time forming the upper canvas; the shuttle then goes again, putting in a weft to form the bottom canvas, and the stitch is then complete; and so it goes on *ad infinitum*, all being automatically performed by the power-loom.

A power-loom in motion looks like machinery gone mad, but controlled by the weaver. He is a wonderful man. Most people think that if they have a dozen things to look after that is enough; a weaver has about three thousand—many out of sight—but he has, practically, to keep his eye on them. Nothing goes wrong without his knowing, and

instantly putting it right. Nothing comes up to a good Kidderminster Brussels carpet for comfort, durability, and style.

### Churches, &c.

The Church of All Saints is a noble building of stone, in the early English style. The earliest record is a charter dated A.D. 736, of Æthelbald (Ethelbald) King of the Mercians to Earl Cynebert, granting ten cassats of land to found a monastery (about 120 acres). It is believed that the monastery built by Earl Cynebert was upon the site of the present Church. It has been conjectured that the mill from which Mill Street takes its name belonged to the monastery. It was destroyed by the Danes, after working about 150 years. No trace of the monastery exists. A church dedicated to St. Mary appears to have been built on the same site by John Niger about 1100 A.D. As preparations were being recently made for fixing the dial of the clock, an inner tower composed of concrete was touched, probably the original tower, round which the present one (which dates from the 15th century) was built. In 1164 the revenues were appropriated by Manser Biset for the support of a hospital for leprous women at Maiden Bradley. Biset held the Manor of Kidderminster at that time. The monastery at Maiden Bradley was dissolved by Henry VIII. A.D. 1536. In 1305 there was built *outside* the Church the chantry of the Blessed Virgin Mary. No trace of this remains. In 1469 was built a chantry within the Church, dedicated to St. Katherine, founded by Lady Jacosa Beauchamp. In 1530 the present chantry was built, by Simon Ryce. On the exterior of the north wall are shot marks of the Parliamentary army. In Baxter's time (1650) there were five galleries. They were reduced to three in 1787. The last restoration was in 1847. The galleries were finally removed in 1872. To describe in detail all the beauties of this Church—its splendid windows, sculptures, and organ, would require a separate work; they must be seen to be appreciated. A guide only cannot do justice to the subject. The living has been held since 1887 by the Rev. Sydney Phillips, M.A.

St. George's Church. This Church was consecrated Sept. 13th, 1824. It is a beautiful stone structure in the

Gothic style ; the tower very ornamental. The Parliamentary Commissioners granted towards building, £16,131 ; raised by voluntary subscription, £2,000 ; total, £18,131. The living has been held since 1887 by the Rev. Theobald William Church, M.A.

The Church of St. John the Baptist was erected in 1843. It is designed in imitation of the Norman style. The cost, amounting to £4,000 was partly defrayed by a bequest of the late J. Woodward, Esq. ; partly by the Society for building churches. The living has been held since 1882 by the Rev. Jno. Frederick Kershaw, M.A.

St. Barnabas' Church, Franche, was consecrated in 1871 as a chapel of ease to All Saints. It is an edifice of brick in Gothic style, erected in memory of the Rev. H. J. Fortescue, M.A., Hon. Canon of Worcester, at a cost of £3010, borne by his daughters. The site was given by the late J. Chellingworth, Esq. The Rev. Charles Stockdale, B.A. has been curate in charge since 1880.

The Mission Church of St. James, erected in 1872 in connection with the Church of St. Mary, near Horsefair, is a plain red brick edifice ; cost about £2,000, wholly given by the Rev. H. J. Fortescue, M.A. The Rev. Robt. Edward Spencer is curate in charge.

The Chapel of the Holy Trinity, Trimpley, was erected in 1844 ; cost £800.

The Roman Catholic Church, situate at the top of Coventry street, Leswell, dedicated to S. Ambrose, was built at a cost of £2,400. The building is very substantial, of red brick with stone dressings and is of Gothic design ; consists of nave, chancel and two aisles, with side chapels. Priest : The Rev. Charles Ambrose Wheatley, Rector.

The Baxter Congregational Church, adjoining the Town Bridge. This building is on the site purchased in 1692 for the erection of a church in which to carry on the work began by Richard Baxter. Since that time two churches have been successively built, viz., in 1750 and 1825 (the old Meeting-house). The latter was removed in 1885 in order to erect the present structure, which is an edifice of red Alveley stone in the early decorated style ; cost £8,406, raised by subscriptions. It is to be regretted that the fine

proportions of this ornament to Kidderminster cannot be seen to the best advantage, owing to the adjacent buildings being so close.

The Baptist Chapel, built in 1867, will seat 600 persons.

The Wesleyan Chapel, built in 1803, seats 600 persons.

The Primitive Methodists' Chapel, built in 1824, has 250 sittings.

The Countess of Huntingdon's Connection, built in 1820, has sittings for 500 persons.

The Unitarian Chapel was built originally in 1782 ; re-opened in 1883, at a cost of £2,600. Seats 700 persons. Baxter's Pulpit is in the vestry. It appears to have been a present to him from Alice Dawks, widow, and there are grounds for believing that it was then an ancient pulpit.

### Public Buildings.

The School of Art, near Exchange Street, is erected on a site given by D. W. Goodwin, Esq., J.P.

Adjoining is a Science and Technical School, completed November, 1887. Cost about £4,000.

The Corporation Buildings (formerly the Kidderminster Public Rooms) were erected by a company and transferred to the Corporation in 1874. The building stands on the old vicarage gardens. The concert hall will hold 800 persons. The orchestra 100 performers. The Corn Exchange adjoins. It is 60 feet long by 35 feet wide.

The Town Hall was erected in 1876 at a cost of more than £8,000. There is a large entrance, wide staircases, municipal offices, council chamber, town clerk's offices, &c.

The Workman's Club, founded in 1856, is in Coventry Street. There is a good library of 2,000 volumes.

The Post Office, in Exchange Street, was erected in 1884.

The Masonic Hall and Club is in Mill Street, and opened in December, 1879. It contains a large lodge room, dining, reading, and billiard rooms, all furnished with taste and comfort.

Gothic style; the tower very ornamental. The Parliamentary Commissioners granted towards building, £16,131; raised by voluntary subscription, £2,000; total, £18,131. The living has been held since 1887 by the Rev. Theobald William Church, M.A.

The Church of St. John the Baptist was erected in 1843. It is designed in imitation of the Norman style. The cost, amounting to £4,000 was partly defrayed by a bequest of the late J. Woodward, Esq.; partly by the Society for building churches. The living has been held since 1882 by the Rev. Jno. Frederick Kershaw, M.A.

St. Barnabas' Church, Franche, was consecrated in 1871 as a chapel of ease to All Saints. It is an edifice of brick in Gothic style, erected in memory of the Rev. H. J. Fortescue, M.A., Hon. Canon of Worcester, at a cost of £3,010, borne by his daughters. The site was given by the late J. Chellingworth, Esq. The Rev. Charles Stockdale, B.A. has been curate in charge since 1880.

The Mission Church of St. James, erected in 1872 in connection with the Church of St. Mary, near Horsefair, is a plain red brick edifice; cost about £2,000, wholly given by the Rev. H. J. Fortescue, M.A. The Rev. Robt. Edward Spencer is curate in charge.

The Chapel of the Holy Trinity, Trimpley, was erected in 1844; cost £800.

The Roman Catholic Church, situate at the top of Coventry street, Leswell, dedicated to S. Ambrose, was built at a cost of £2,400. The building is very substantial, of red brick with stone dressings and is of Gothic design; consists of nave, chancel and two aisles, with side chapels. Priest: The Rev. Charles Ambrose Wheatley, Rector.

The Baxter Congregational Church, adjoining the Town Bridge. This building is on the site purchased in 1692 for the erection of a church in which to carry on the work began by Richard Baxter. Since that time two churches have been successively built, viz., in 1750 and 1825 (the old Meeting-house). The latter was removed in 1885 in order to erect the present structure, which is an edifice of red Alveley stone in the early decorated style; cost £8,406, raised by subscriptions. It is to be regretted that the fine

proportions of this ornament to Kidderminster cannot be seen to the best advantage, owing to the adjacent buildings being so close.

The Baptist Chapel, built in 1867, will seat 600 persons.

The Wesleyan Chapel, built in 1803, seats 600 persons.

The Primitive Methodists' Chapel, built in 1824, has 250 sittings.

The Countess of Huntingdon's Connection, built in 1820, has sittings for 500 persons.

The Unitarian Chapel was built originally in 1782; re-opened in 1883, at a cost of £2,600. Seats 700 persons. Baxter's Pulpit is in the vestry. It appears to have been a present to him from Alice Dawks, widow, and there are grounds for believing that it was then an ancient pulpit.

### Public Buildings.

The School of Art, near Exchange Street, is erected on a site given by D. W. Goodwin, Esq., J.P.

Adjoining is a Science and Technical School, completed November, 1887. Cost about £4,000.

The Corporation Buildings (formerly the Kidderminster Public Rooms) were erected by a company and transferred to the Corporation in 1874. The building stands on the old vicarage gardens. The concert hall will hold 800 persons. The orchestra 100 performers. The Corn Exchange adjoins. It is 60 feet long by 35 feet wide.

The Town Hall was erected in 1876 at a cost of more than £8,000. There is a large entrance, wide staircases, municipal offices, council chamber, town clerk's offices, &c.

The Workman's Club, founded in 1856, is in Coventry Street. There is a good library of 2,000 volumes.

The Post Office, in Exchange Street, was erected in 1884.

The Masonic Hall and Club is in Mill Street, and opened in December, 1879. It contains a large lodge room, dining, reading, and billiard rooms, all furnished with taste and comfort.

The Infirmary is situated at the upper end of Mill Street. In 1886 the fever wing was transformed into a children's hospital, through the benevolence and at the cost of Thomas Lea, Esq., M.P., J.P.

### Statues.

The memory of Sir Rowland Hill, K.C.B., who was born here December 3rd, 1795, has been perpetuated by the erection, in 1881, of a marble statue near the Town Hall, at a cost of about £1,700.

In the year 1640 the celebrated Richard Baxter (born 12th November, 1615, at Rowton, Shropshire), became by invitation the minister of this town, but, on the breaking out of the civil war, he undertook the duties of chaplain in the Parliamentary army. On account of some passages in his paraphrase of the New Testament he was imprisoned, but released on the mediation of Lord Powis. He died 8th December, 1691. He resided in High Street, where Mr. Lane now lives. The statue is of white marble; it was modelled by F. Brock, Esq., of London, at a cost of £1,200. Kidderminster may well be proud of this memorial. It is a masterpiece in attitude and expression. There is no grander statue in England.

A Drinking Fountain (the gift of John Brinton, Esq., late M.P. for the borough) was erected in 1876, near Worcester Cross.

A Drinking Fountain and Cattle Trough was erected in 1883 at Blakebrook, the site and cost of which was defrayed by D. W. Goodwin, Esq., J.P.

### Places of Beauty and Interest.

#### HABBERLEY VALLEY

Is about two miles from Kidderminster. From time immemorial this has been a place of resort to all seekers of lovely scenery and the picturesque. By a recent act of munificence it has been thrown open to the public by J. H. Crane, Esq., of Oakhampton, as a jubilee gift. The finest view will be obtained by taking the main road to Trimpley, over the Ridge Rock. On a clear day may be seen

Malvern, Abberley Hills, Clee Hills, Clent Hills, Kinver Edge, &c. In the foreground is the valley itself. The variations of light and shade, colour and outline, form a charming picture. The Peaked Rock, or Peckitt Rock, rises suddenly from the valley; with ordinary traffic it would wear away perhaps an inch in a thousand years. There are channels and foot-holes eighteen or twenty inches deep worn simply by the tread of human feet,

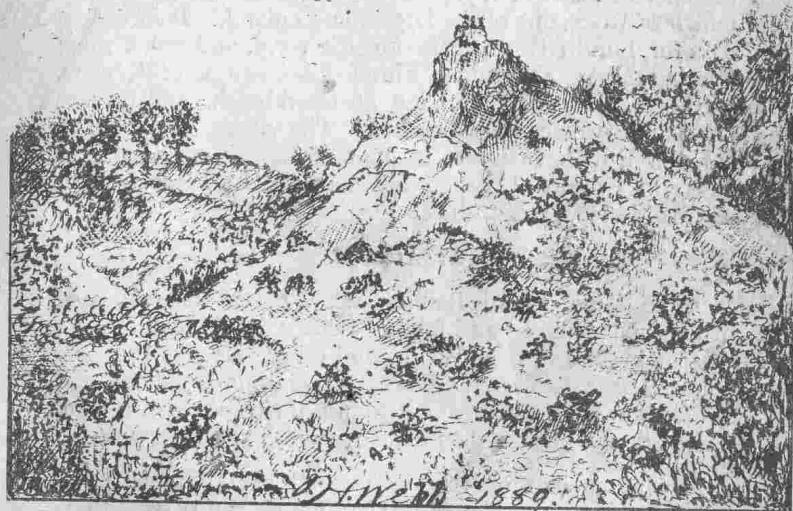

THE PEAKED ROCK.

HABBERLEY VALLEY.



so that for the last 20,000 years tourists have had a good time at the valley. At the foot of the rock is the Giant's Grave (a mound), of which the legend says: "Fingal was a giant; he had been drinking; fell off Peckitt rock. The fall was fatal. Too big to move, peasants covered him up, so there he lies." Jacob's Ladder is at the far end of the Ridge Rock—a series of steps by which the rock is climbed. Jacob's Well is about half-a-mile away, at Trimpley.

### Trimpley.

This place is about three-quarters of a mile beyond the valley. It adjoins Eymore Woods, which formed part of the ancient forest of Wyre—a vast forest extending over the parish of Rock, one of the largest in England. It furnished oak for hundreds of years for the navy, and was a great hunting place, abounding with foxes, badgers, wild boars, and deer. Hawks abounded at Hawkbatch, and owls at Owlbatch; wolves were plentiful. The village of Wolverley is believed to have taken its name from this circumstance. In 1280 Edward I. issued his mandate to Peter Corbet, of Chaddesley Corbet, thus:—

#### *Translation.*

"The King, to all Bailiffs, &c. *Know* that we have ordered our beloved and faithful Peter Corbet to take and destroy in all forests and parks and other places within our counties of Gloucester, Worcester, Hereford, Salop, and Stafford, in which wolves are found, the *Wolves*, with men, and dogs, and his own devices in every way he thinks proper."

A very ancient church once stood at Trimpley; not a trace remains. In Henry VIII's time a chantry was there dedicated to the Blessed Virgin. A modern church now stands on the site.

### ENGLISH WOLVES.



AN OLD WOLF.



A YOUNG WOLF.





*Where a Road was infested with Wolves, Wolf Houses were sometimes erected to provide a place of safety for those pursued.*



TWO OF THE LARGEST POPLAR TREES IN WORCESTERSHIRE,

IN FRONT OF THE "TAP-HOUSE,"

AT BLAKEBROOK, KIDDERMINSTER. 1838.

### Upper Arley.

This village is situated on the banks of the Severn, about six miles from Kidderminster. It can be reached by rail from Bewdley or Kidderminster; and a splendid row can be had upon the river starting from Bewdley Bridge, where boats of all kinds can be hired at a reasonable rate.

#### A ROW ON THE SEVERN.

Following the course of the river, the distance from Bewdley Bridge to the "Valentia Arms" at Arley is about four and a half miles. At all times it is as well to have one person in the boat who has some knowledge of the stream, but in low water it is necessary that the steersman should be well acquainted with the channel of the various fords. The most formidable of these are *The Roundstone* ( $1\frac{3}{4}$  miles), *The Folly* ( $2\frac{1}{4}$  miles) and *The Seckley* (3 miles). Starting from Bewdley the first ford is at Dowles (three-quarters of a mile). In low water it is necessary to keep to the *right* hand bank (*i.e.*, the right hand bank looking up stream) until the top of the ford is reached, and then steer under the centre arch of the railway bridge. On the left is Dowles Brook and Dowles Church. Some 400 yards above is *The Bridwell* ford. The water here is strong and rough; the channel is close to the *left* hand bank. At the head of the ford, on the *right* hand, is a broad sheet of very deep water, in which, at certain times, awkward whirlpools are formed. Next comes *The Roundstone*, probably the most dangerous ford in the Severn. With the river fairly full it is possible to ascend the *left* hand side, but in low water the only channel is close to the *right* hand bank. The peculiarity of the ford is that the stream runs strongly over a shelf of sandstone, and at the same time makes a sharp turn into the *right* hand bank. At the top of the shelf the water is two feet deep; four yards below it is ten to fifteen. Above *Roundstone* the stream is quiet until *Folly* ford is reached; just below it are two large sharp stones, an oar's length from the *right* hand bank, known as the *The Bear's Back*. *The Folly* ford itself is at a sharp bend of the river, and in ordinary water, the only passage is close to the *left* hand bank. From this point to Arley the scenery is of marvellous beauty. Up and down stream the view from early spring to late autumn is exceptionally even for the Severn Valley. A hundred yards above *The Folly* is a long island; at times it is necessary to take the *right* hand channel where the water is very rough but

not particularly difficult. Above is a beautiful reach of very deep still water. The next 400 yards tries the endurance of the rower, and he then meets *The Seckley* ford. The passage here is rather to the *left* of the centre of the river. Immediately above is a large island almost adjoining the *right* hand bank. The rower, still in fast water, keeps to the *left* hand course, and at the top of the island meets with his reward in a long stretch of quiet water, under the Severn Valley railway bridge to *The Mill* ford. This is never formidable, and 400 yards more of easy rowing brings the boat abreast of the village. Above Arley the stream is very straight for three quarters of a mile. To those who can swim, bathing is fairly safe, except in the vicinity of the fords. The river bed, however, is very uneven, and some care is necessary. Fishermen and rowers are sometimes tempted to wade in the shallow water at the top of the fords. It is dangerous to do so, especially above *Folly* and *Roundstone*. (See Map of the River on next page).

On reaching Arley the tourist will see a most picturesque village with scenery rarely equalled. The Castle is a large stone building next the venerable Church. Visitors can walk round the grounds, and, with permission from the gardener, see Naboth's vineyard—a wild overgrown dell with waterfalls, and an utter absence of trimness. There is fishing to be had in the river, and no lack of comfort and accommodation at the "Valentia Arms."

### Bewdley.

An ancient town, about three miles from Kidderminster, can be reached by road or rail. The place is so remarkable for its beauty and history that a simple Guide-Book cannot do justice to the subject. Readers are referred to "A History of Bewdley, with Concise Accounts of some Neighbouring Parishes, by John R. Burton, B.A., F.G.S., Rector of Dowles, 1883." The earliest mention of the modern Bewdley occurs under its old Saxon name, Wribenhall. See *Domesday Book* (1085). A great trade was formerly carried on here in boat-building, the oak being had from the Wyre forest. In 1412 the citizens of Bristol and Gloucester petitioned that goods and merchandise should be allowed to pass in their own vessels through Bewdley without hindrance. It appears that black mail was levied by a band of lawless men, notably at Blackstone Rock. There were

produced in Bewdley great quantities of drinking horns, combs, bows and arrows, flannels, tanned leather, caps, &c. These wares were conveyed upon the backs of pack-horses; as many as 400 have been stabled in the town in a night.

BLACKSTONE ROCK is upon the banks of the Severn, about a mile below Bewdley. A hermit once lived there in the rooms which were cut out of the rock. The tourist is warned not to be tempted by the placid appearance of the river to bathe near this rock. There are cross currents on the surface, but the under currents are highly dangerous; moreover, the temperature varies, and many expert swimmers have been lost. (See Plan of Hermitage on next page.)

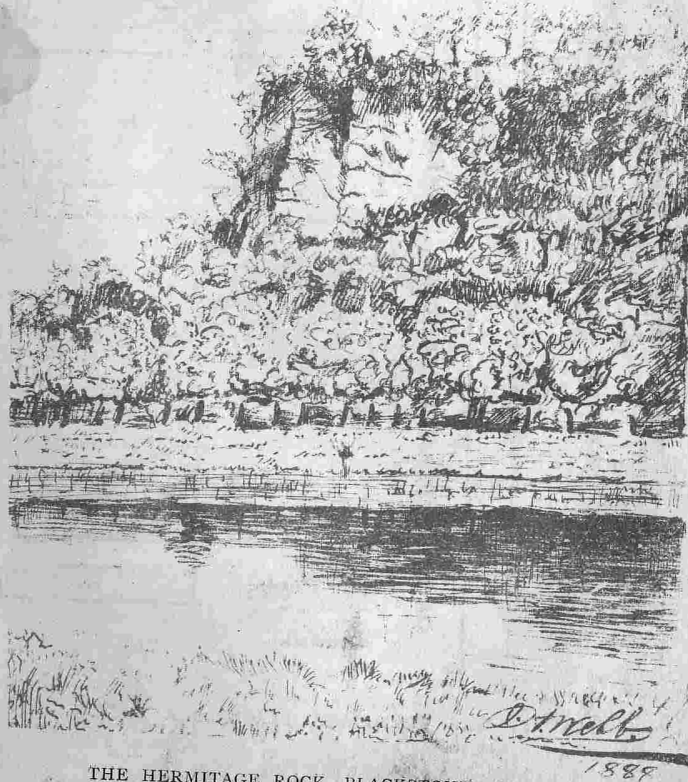

THE HERMITAGE ROCK, BLACKSTONE.

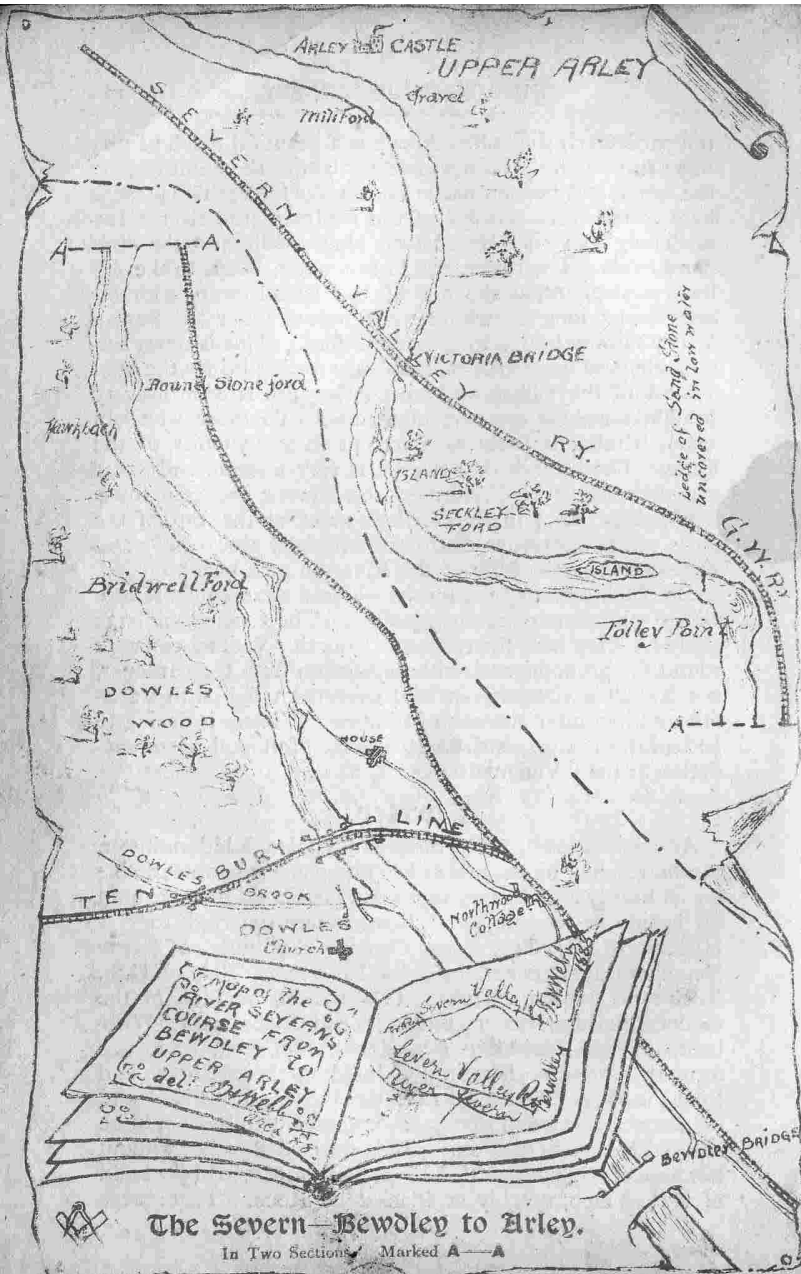

The Severn - Bewdley to Arley.

In Two Sections. Marked A-A



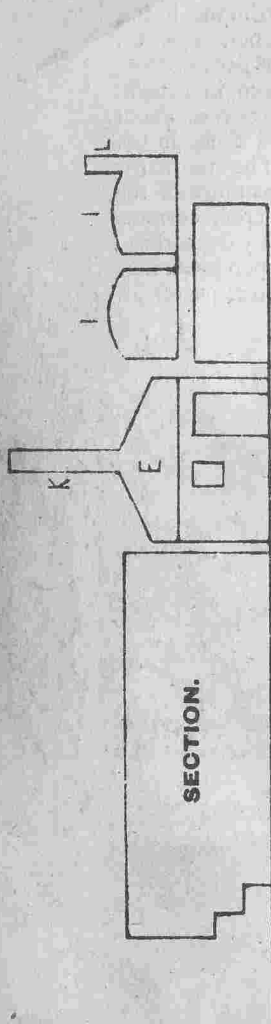

PLAN OF THE HERMITAGE, BLACKSTONE ROCK.

## GROUND PLAN &amp; SECTION, TAKEN 1721.

The lettering is as follows:—

- A.** Hermitage Chapel  
**B.** The Altar  
**C.** The Common Room  
**D.** The Pantry with—  
**E.** Chamber over it  
**F.** The Study  
**G.** Shelves for Books  
**H.** An Inner Room  
**I.** Closets & Lofts over  
**J.** Belfry  
**K.** Chimney

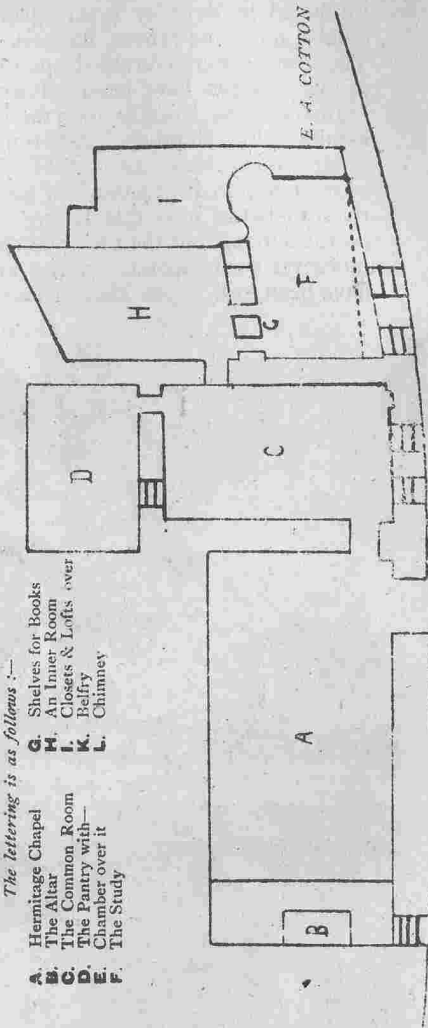

## Ribbesford.

About a mile from Bewdley is the famous Cherry Orchard. In the spring acres upon acres of white blossoms can be seen. Every kind of cherry tree is there. The orchard is approached through an avenue of noble trees, considered the finest in the County, and leading to the ancient Ribbesford Church.

*Legend—*

“A knight was paying suit to a lady but met with no encouragement from her father, who said that he should



(The Carving over the Porch belongs to the earlier part of the Norman period.)

not marry her unless he could kill two creatures at the same time with one arrow. The knight was walking sadly by the river and saw a deer drinking, he shot at it, and the arrow passed through its neck and killed a salmon.” This is the subject of the carving. The legend is pretty but takes a deal of believing. The salmon has *two fore legs*. It really looks more like a beaver.

## MOUNT STAGBOROUGH.

About two miles from Bewdley, on the road to Stourport and on the right side of the river Severn, is a hill named as above. From its summit there is an impressive view not surpassed in the county. Very few persons know of the place, and it would be well to secure a guide at Bewdley. The path through the Ribbesford and Walham woods is difficult to find—even Malvern does not present a scene to surpass this. The winding Severn can be traced for miles. In the distance can be seen Abberley, Trimpley, Clent Hills, and many other places. The tourist at Bewdley need scarcely enquire where he shall go to find lovely scenery; he is in the middle of it.

## Harvington, near Chaddesley Corbett.

## OLD MANOR HOUSE AND MOAT.

About four miles from Kidderminster may be found a most interesting and ancient Catholic mansion. In it will be seen the unique hiding places of the Catholic Priests, persecuted some three hundred years ago. Harvington formed part of a vast domain. An ancient baronial building stood upon the present site, once the seat of the Corbets, who have been located there 800 years. At one time the place teemed with wolves, and Edward I, as before noted, issued a mandate to Peter Corbet to destroy them. Part of the building is over 400 years old. In December, 1683, a Kidderminster mob proceeded to attack the mansion. The drawbridge was up and the occupant, the aged Lady Yate, stood within the oaken doors—she was shot at but escaped; the hole is still there. Some of the massive beams have slits cut through them in order to pass food or letters to the secreted priests. In one place is a three-cornered stair, which has secret hinges. There is a hiding-place under. The place is full of interest and will well repay the antiquarian for a visit.



## Rides and Walks.

*General Remarks—*

Everything good to eat and drink that tourists may wish to supply themselves with can be had at Kidderminster. The country people round are polite. Any enquiries will be answered without awkwardness or servility. The roads are admirable, drying immediately after rain. All the farms, cottages, and holdings have a well-to-do look and no sign of poverty.

1. Ride to Bewdley, Bine Mill, Bliss gate, Dunley, Arley Kings, up Severn side, Ribbesford, Cherry Orchard, and Bewdley, home. Time—four hours; one horse and man, cost about 10s.
2. From Kidderminster, Towards Bewdley turn to left to Devil's Spadeful, enter road to Stourport, Wood Green, Lickhill, Stourport, Hartlebury common, Hartlebury, home—about three hours, 9s. 6d.
3. Kidderminster to Stone (see Harvington) Chaddesley, Drayton, Belbroughton, Clent, Hagley, Blakedown, home,—about three hours, 9s. 6d.
4. Kidderminster to Cookley, Kinver, (short to left notice the rock houses along a lane full of ferns,) Kinver Edge and Encampment on left, Blakeshall, and more houses in rocks, Baxter's Monument, The Lowe, home—3½ hours, 9s. 6d.
5. Kidderminster to Shatterford Hill. Turn towards Trimpley (notice Wyre Forest to right), back of Wars-hill, past Warstone Farm, Bewdley, along Habberley road, Bach's Hill, home—3½ hours, 9s. 6d.
6. Leave Kidderminster Station for Wyre Forest Station. Walk to Bewdley by side of Dowles Brook then home. The walk through Forest—about 4½ miles—rail 8 miles.
7. Rail to Stourport. Walk to the Dick Bridge, then turn to right to Abberley Church, Netherton, the New House, Worrall's Mill, Stourport, home—walk about 11 miles and 8 rail.
8. To Franche, The Lowe, Castle Hill, Start's Green, Greyfield, High Trees, Bellman's Cross, Upper Arley Station, rail home—Altogether 9 miles walk—rail 8 miles.
9. To Stone, Fenny-rough, Harvington, The Dane's Ford, Bellington, Blakedown Station, home—Altogether 10 miles walking.



10. 'Bus to Bewdley (get a boy guide)—Bark Hill, through the Forest to the old rifle ground; inspect some fishponds. In the vicinity are houses fitted up with tanks for rearing salmon and trout; thousands may be seen in all stages of growth. There are eight ponds altogether; give keeper something. At last turn to the left into the Cleobury road, home, *via* Bewdley—about 14 miles—6 rail.

11. Upper Arley by rail; enquire for Nib's Green, Fastings Farm, "Eagle and Serpent," Dowles Road, Bewdley, home by rail—altogether 17 miles—9 by rail.

Other rides and walks can be found full of interest and pleasure.

G. W. R.

### Table of Cab fares

TO BE CHARGED FROM KIDDERMINSTER STATION.

	s.	d.		s.	d.
Bull Ring ...	1	0	Broadwaters ...	2	0
Horsefair ...	1	0	Haberley Valley ...	2	6
Chester Road ...	1	0	Stone House ...	2	6
Comberton ...	1	0	Spring Grove ...	2	6
Mill Street ...	1	0	Harvington ...	3	0
Bewdley Street ...	1	0	Wolverley ...	3	0
Park Butts ...	1	0	Winterfold ...	3	0
Hurcott Road ...	1	6	Cookley ...	3	0
Leswell ...	1	6	Bewdley ...	3	0
Blakebrook ...	1	6	Stourport ...	4	0
Infirmary ...	1	6	Hartlebury ...	4	0
Sutton Common ...	1	6	Chaddesley ...	5	0
Clensmore ...	1	6	Kinver ...	5	0
Hurcott ...	2	0	Arley ...	6	0
Franche ...	2	0	Witley, Hundred-house ...	0	0
Stone ...	2	0	Witley Court ...	10	0

All other places 1s. per mile.

### Omnibus Time Tables.

BETWEEN KIDDERMINSTER & BEWDLEY.

Leaving "Swan Hotel," Kidderminster.			Leaving Bewdley.		
MONDAY.....	a.m.	p.m.	a.m.	p.m.	
TUESDAY ...	11.15	2.15 6.30	9.30	12.45	5.30
WEDNESDAY					
FRIDAY .....					
THURSDAY	a.m.	p.m.	a.m.	p.m.	
	9.30	11.15 2.0	9.0	9.30	12.30 12.45
		2.15 4.30 6.30		3.30	5.30
SATURDAY	a.m.	p.m.	a.m.	p.m.	
	9.15	2.15 6.30 10.30	9.30	12.45	5.30 8.0
SUNDAY..		2.45 8.0		p.m.	
				2.0	7.0

BETWEEN KIDDERMINSTER & STOURPORT.

Leaving "Wheat Sheaf," "Cape of Good Hope," and "Half-Moon," Kidderminster.			Leaving "Crown and Anchor," Lower Mitton, Stourport.		
MONDAY.....	p.m.		a.m.	p.m.	
TUESDAY ...	1.0	5.30 7.0	10.30	2.0	5.30
WEDNESDAY					
FRIDAY .....					
THURSDAY	p.m.		a.m.	p.m.	
	1.0	4.0 5.30 7.0	10.30	2.0	2.30 5.30
SATURDAY	a.m.	p.m.	a.m.	p.m.	
	1.0	4.0 5.30 8.0	10.30	2.0	2.30 5.30 6.30 8.45
		p.m. p.m.			
		9.0 10.0			
SUNDAY	p.m.		a.m.	p.m.	
	12.30	2.30 8.45 9.30	10.30	2.0	7.20 8.30

The 7.20 p.m. from Stourport on Sundays meets the Birmingham Train at Kidderminster.

PARCELS RECEIVING HOUSES—

Crown and Anchor, Lower Mitton, Stourport.

Wheat Sheaf, Worcester Street, and Cape of Good Hope, New Road, Kidderminster.

bur ryndon pa zemæpu pe <sup>by pas</sup> eo keoþelan hezad  
 these are the boundaries that to Hartlebury belong  
 æþere or yeupe on þa dic ær ruddene  
 First from Stour to the ditch at Southden  
 ondlang dicer eo þam heapdnn abe þam  
 Along the ditch to the head. Close by  
 heapdnn on þreo lapar  
 the head to the three hills =  
 Translation of Saxon boundary: Hartlebury =

### Old Legends.

Two uninteresting legends vouched for as being perfectly untrue in every particular.

#### 1. THE DEVIL'S SPADEFUL.

"Many years ago a travelling bootmender was on his way from Blackstone Rock, near Bewdley, to Kidderminster. He had a sack on his back full of worn boots. When about a mile on his way he met Satan, who was carrying an enormous shovelfull of earth and rock. He said he intended putting his load in Severn and so drown Bewdley, and asked how far off that town was. The man concocted what may fairly be considered the champion untruth of the year. He said Bewdley lay at an inconcievable distance and that he had worn out the sack full of boots in walking from the place which he emptied at Satan's feet. Satan then emptied about a million tons of rock over the cobbler, at the same time thanking him for his information." The mound is still there shewing how Bewdley was saved. It is called the Devil's Spadeful.

#### 2. THE ROUND HILL, CALDWALL.

At the junction of Park Lane with the Stourport Road there is a round hill, so perfect in its shape, that tradition says it was thrown up in a single night by Cromwell's soldiers, who next day proceeded to demolish St. Mary's Church, and that the marks of the cannon balls can be plainly seen on the stone work of the Church." The mound is really rock, thinly covered with soil and vegetation. A spring rises here, having medicinal qualities. The cannon ball marks are all on the other side of the Church. This wants some explanation.

### Coaching about 50 years ago.

Kidderminster, about the year 1840, could boast of good through connections with nearly all the principal lines of coaches then existing. In these days of rapid motion it may be interesting to glance at the means of transit by which the business of the old firms was carried on. At the date before mentioned the following Coaches passed through Kidderminster daily, (Sunday excepted)—*L'Hirondelle* Cheltenham to Liverpool; *Hibernia*—Cheltenham to Liverpool; *Red Rover* and *Day Mail*—Birmingham to Ludlow; *Royal Mail*—Birmingham to Ludlow; *Bang-up*—

Wolverhampton to Worcester; *Everlasting*—Wolverhampton to Worcester; the *Greyhound*—Birmingham to Kidderminster; the *Hawk*—Cheltenham to Shrewsbury; Jordan's 'Bus—Kidderminster to Birmingham; Gardner's 'Bus—Kidderminster to Birmingham, and Kidderminster to Worcester. The *L'Hirondelle* and the *Hibernia* were considered the fastest Coaches on the road, and on one occasion the journey from Kidderminster to Worcester (14 miles) was done in forty minutes. The fare at one time was 6d. only. The average speed was twelve miles an hour. Occasionally, the speed caused one of the wheels of the *Red Rover* to take fire. A spare wheel was always lashed on back of Coach, and in a few moments the change was made. The arrival of these Coaches was a never-failing source of interest. Annually on the 1st of May the horses of each Coach had new harness, and the coachman and guards new coats and hats; the horses were decorated with flowers, and the guards enlivened the occasion with music from their cornets. The celebrated whip, Jordan, was coachman of the *L'Hirondelle*. At this time sixty horses were kept at the Lion Hotel. All these things changed on the opening of railway, on the 1st May, 1852—Mr. Chambers being the first station master.

The Mr. Jordan mentioned performed wonders with his whip. He would sometimes, in coming down Hagley hill, lasso a duck at the *Fountain*, landing it on the lap of the passenger on the box seat. At the *Swan* Inn he would place half-dozen tumblers on the dining table and neatly take out the spoons without upsetting the glasses.

It may not be out of place to mention here that the goods from the manufacturers and others, also goods received were conveyed by canal boats and by Jolly's wagon, which took nearly a week in the journey to London. The arrival and departure of the wagon here and in London always attracted an assembly of people; and many are the tales told of incidents on the journey. The team consisted of ten and sometimes thirteen fine black horses and often have the coaches had to wait for their assistance on difficult roads in bad weather; the driver would frequently take his children with him, whose sleeping-place was in the hay bags, and no doubt there are many who have a pleasant recollection of the time of Jolly's wagon and the coaching days, now superseded by the "iron horse."

### Antiquities, Old Streets, Roads, &c.

One of the oldest roads from Bewdley to this town began at Wribbenhall, its course lay over the Common, opposite Spring Grove, at the side of the late Vicarage, then through the fir trees near, and joined Kidderminster at the bottom of Summer Place. It was a pack-horse road. At this time there was no cutting in the sandstone rock in Bewdley Street. The horses traversed a narrow path leading to the middle or bottom of Carpet Hill. An old practice ground for archery is believed to have been near the foot of the Hill. When a cutting was made it was steep and narrow and in order to prevent horses meeting, a man was stationed at the entrance who blew a horn to announce that a horse was in the cutting. The *Horn and Trumpet* Inn is said to have taken its name from this custom. The junction of this old road with Mill Street is now nearly sixty feet wide; a hundred years ago it is shewn as a narrow lane called "Bewdley lane." (See Map of Kidderminster, 1780).

### Ancient Querns found at Kidderminster.

In the latter end of the year (1879), a dilapidated, half-timbered, XVI century house, adjoining *Three Tuns*' Inn, was being taken down for the purpose of being rebuilt, from the designs of Mr. Gething, when, in the pebble floor of an outbuilding at the rear, and some thirty yards from the river Stour, a fine pair of querns were found. They are of extremely hard, coarse grit, dark in colour and apparently of volcanic origin, and in an unusually fine state of preservation; all the furrows being perfect, but ground somewhat shallow. The upper stone (the one represented in the left of the sketch) measures  $14\frac{1}{2}$  inches in diameter and  $3\frac{1}{4}$  inches in thickness, and still has leaded-in across the eye upon its face, the iron bar with the sunk centre upon which it turned. The upper side or back of this stone has three holes, at equal distances round the eye, and two others near the outer circumference; also the letter V (or numeral five) incised to the depth of about the eighth of an inch. The lower stone also measures  $14\frac{1}{2}$  inches on the furrowed face; but the edges being bevelled, the back is reduced about one half inch. It is  $2\frac{1}{2}$  inches thick, and distinctly shows its furrows, but is ground down somewhat more than the top stone. (See drawing on next page).

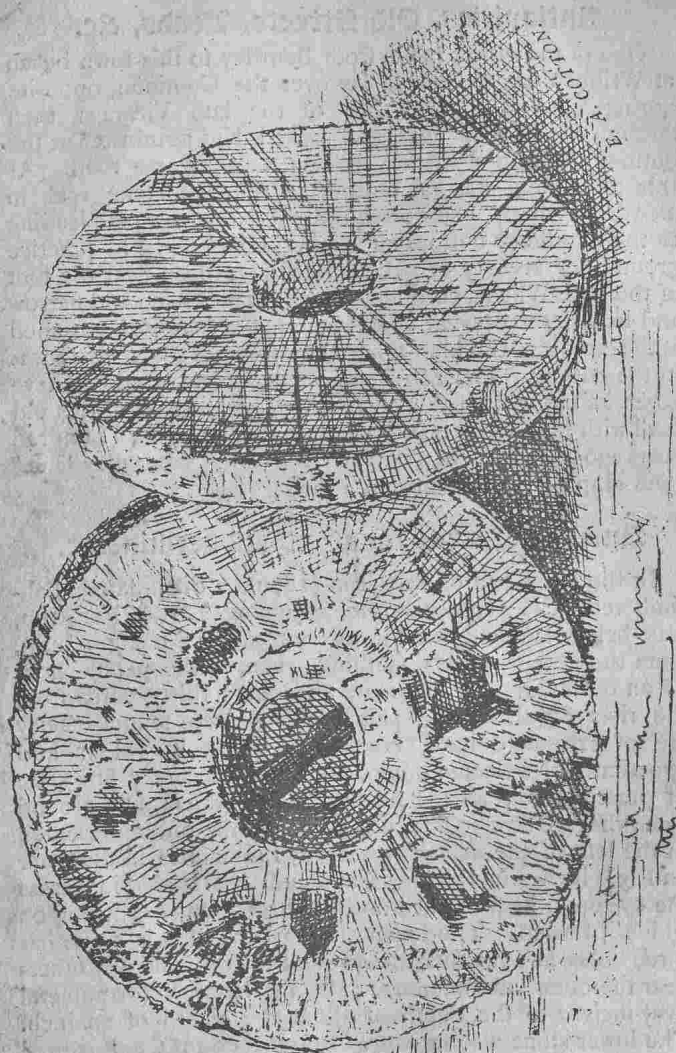

ANCIENT QUERNS (GRINDING STONES FOR GRAIN)

Found at Kidderminster.

### THE CALLOWS LANE.

The river was fordable here. In 1814 the present bridge was erected, before that time there was a very narrow plank bridge.

### THE TOWN BRIDGE AND BULL RING.

In making some improvements to the bridge about sixty years ago, the builder, at a depth of about four feet, came upon the old street leading to a ford of the river Stour. It was paved with large round stones. The street and Bull Ring has been raised about four or five feet. Two houses now remain at the old level.

In sinking to make the foundation for Baxter's Statue in the Bull Ring, the post and ring used when bull-fighting was a sport, was found. A pleasant path, shaded with trees, ran at the side of the Stour from the Bull Ring towards Caldwell Hall.

### VICAR STREET.

The land lying between this street and the Stour was once a *soake*, i.e. a stretch of low lying spongy soil, which acted as a drain to Worcester Street and Lion Fields. In erecting Messrs. Barton's premises, the builder came to a set of ancient oak piles black with age. There were no marks of the saw upon them, but had been roughly dressed with the axe. It is supposed that at some remote time there were habitations thereon. A large quantity of bones were found, also some horns.

On turning down the passage next the *Three Truns*, another relic may be seen upon the near premises to which the ancient Querns were found. It is a door now in use at the back of Mr. Cheshire's Stationer's shop, and is dated "1674," with the initials "D W I" upon it, made with square headed iron nails, of which there are a great number.

### CALDWALL CASTLE.

Tradition states that there is a subterranean passage from this venerable building to St. Mary's Church. The entrance is choked with rubbish. In Coventry street (in a line between the castle and church), forty years ago, was discovered an ancient crypt. The entrance is through a semi-circular arch of Saxon or Norman style. There is an



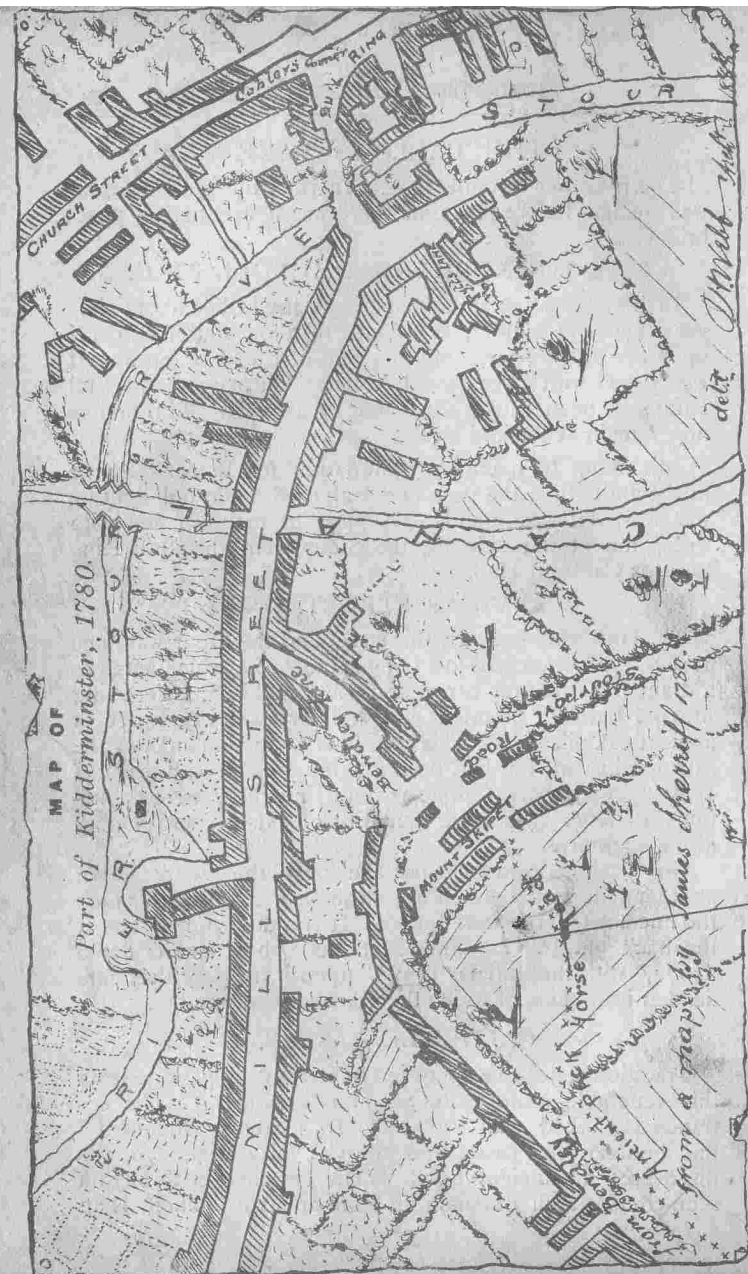

inner cell ; this is divided by a wall having an oblique opening, through which persons used to behold the "elevation of the host" at a neighbouring altar. This passage appears never to have been carefully examined by antiquarians.

### Old Customs.

#### BANNERING.

The custom is now obsolete. It consisted in walking round the boundaries of the parish—this was done by the High Bailiff, heralds, and a crowd of followers. The proceedings generally ended in a fight with some other Bannerers from a neighbouring parish.

#### HEAVING.

Another custom obsolete. On Easter Monday and Tuesday, the men lifted the women in the air and kissed them, and the woman lifted the men. A money bribe generally freed the victims captured in the streets.

#### APPLE-THROWING. *Now obsolete.*

The apple throwing was done on the day the Bailiff of Kidderminster was elected. Apples were thrown from the window of the old Town Hall and sometimes down the market steps, a pot at a time. It was a scene of great confusion ; those on the outside of the crowd taking the apples off those in the centre as they came pushing out with their booty. It ceased when the *Municipal Act* came into force.

The Bridgworth Fair is held on St. Luke's Day, and the 8 o'clock bell rings one hour longer. Many years ago a farmer, riding from Bridgworth, lost his way on the Ridge Rock, Habberley, and in a few moments would have been over the precipice, when he heard the bell and regained the road. He left money to pay for the bell to be rung annually.

#### Readings at Public Houses.

This was an ancient custom, and was discontinued about 50 years ago. The *Plough Inn*, *Leopard* and *Duke of York*, were favourite places, and the reader was thought a deal of in those days ; he had his refreshments free, and read from the



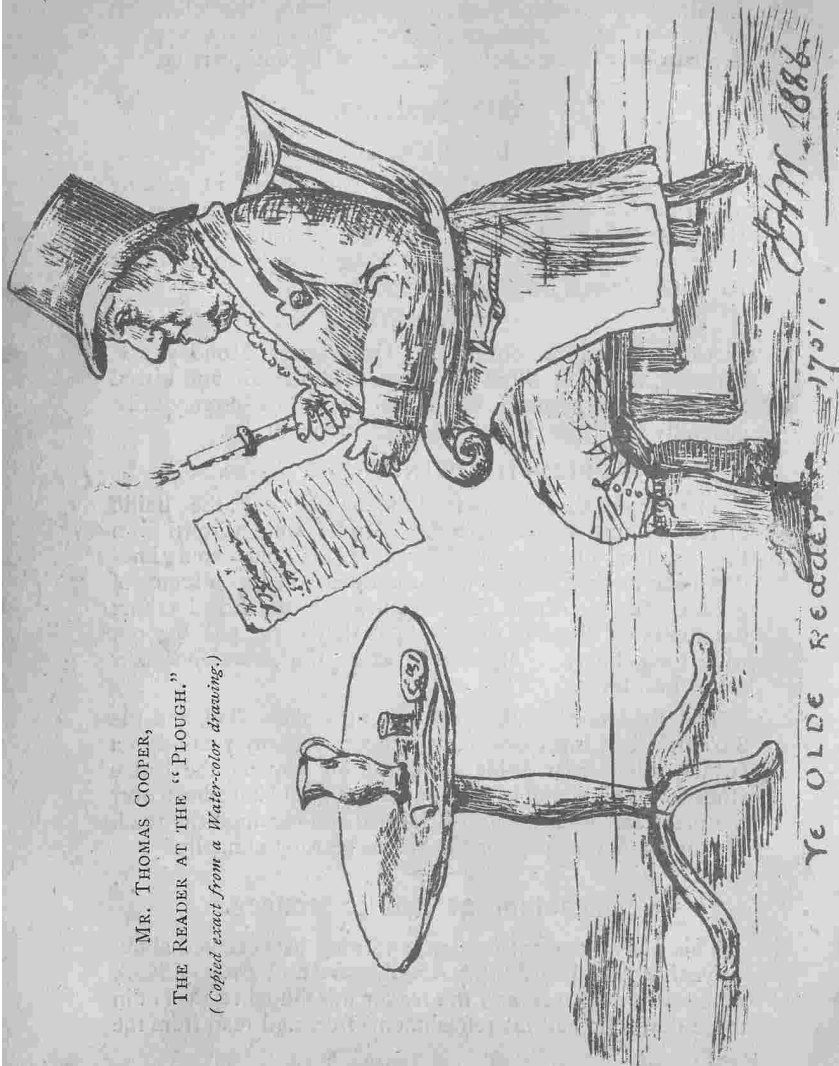

MR. THOMAS COOPER,  
THE READER AT THE "PLOUGH."  
(Copied exact from a Water-color drawing.)

papers about an hour upon any subject called for by the company—politics, trade, war, &c. Many persons at that time could not read, and public information was thus obtained in a quiet pleasant manner. One reader (a tailor) who generally read to a company of tailors admitted that whenever he came to a hard word he always said "sleeve-board." At the close of the reading the company indulged in discussion.

### Industries now Extinct.

*Bombazines, Silks, Cordage (chiefly for Looms) and Horsehair.*

#### BOMBAZINE.

About 1830 the manufacture of Bombazines was brought to great perfection. The material was very soft, and had a beautiful appearance. It was made of silk and worsted, and was the fashionable fabric of the day. Now there is not a loom in the town; by a freak of fashion the demand suddenly ceased, although no modern production has equalled the fabric in finish and rich colouring, which were chiefly clarets and moroons.

#### SILK.

The late William Grosvenor, Esq., introduced the Weaving of Silk here. In the Exhibition of 1851, a piece was shown which was specially noted by Her Majesty, who enquired where it was made, and admired the way in which the pattern showed on both sides, and the richness of the texture. This gentleman also introduced a material for covering buttons, and had works to turn out all kinds of cordage and twine specially used by carpet manufacturers. It is much to be deplored that, upon the retirement of Mr. Grosvenor from these trades, no one carried them on.

About 1855, a great change took place in the carpet trade; steam looms being introduced to supplant, in a great measure, the old hand looms. It was at this important juncture that Lord Ward erected the Steam Loom Sheds at Stour Vale, which were placed under the management of the late Mr. William Grosvenor and Mr. Joseph Kiteley.

### The Railway.

It is said that the present Passenger Station was being built in Scotland for Stratford-on-Avon, when the former

station was burnt down about thirty years ago. It was brought here and erected to meet the necessity for immediate accommodation. Its architecture connects it with Shakespeare, and it is a novel structure, encased on the side nearest the line with encaustic tiles, but is not always equal to the demands of the present traffic, which has greatly increased. The railway passing through here was originally called "The Oxford, Worcester, and Wolverhampton Railway," and it subsequently passed into the hands of the West Midland and Great Western Companies. The "broad guage" was first laid down, and one train or more ran over it to meet the requirements of the Act of Parliament; it was then taken up and connected with the surrounding "narrow guage" systems. This section was opened in June, 1852. The chief traffic consists of carpets, wool, yarns, dyes, tin plates, coal, coke, moulding sand, grain, fruit, vegetables, and hides, forming an aggregate annual tonnage of 130,000 tons. This is doubtless the most important station, as regards traffic, on the Great Western Railway between Wolverhampton and London, excepting Worcester and Oxford for passenger traffic, and Reading for passenger and goods traffic. For years after the line was opened the accommodation for traffic was very limited, but within the last dozen years two very fine goods sheds have been erected at a cost of several thousands of pounds, while the goods yard has been re-arranged and re-laid. The old wooden Viaduct, at Hoobrook—one of the Brunell structures — has also been replaced by a magnificent brick one, which cost nearly £30,000. There is a Station Master, Goods Agent, and a staff of about 50 men.

### Attempt to make the River Stour Navigable.

Andrew Yarrington was born at Astley, near Stourport. He had travelled through Holland, Germany, and many other countries to bring home something to improve our manufacture. His favourite schemes were to render rivers navigable, and prevent fires in London. In 1698, his scheme to make the Stour navigable proved abortive through want of money. He really made the River navigable, and many hundreds of tons of coal were brought from Stourbridge. During the close of the last century, some parts of the boats made use of were found embedded in the Stour.

## Kidderminster Post Office—Local Arrangements.

GENERAL OFFICE: EXCHANGE STREET.

### OUTWARD MAILS—WEEK-DAYS

Letters may be Registered until Half-an-hour previous to the time of closing the Letter Box.

	TOWN RECEIVING OFFICES AND WALL BOXES.	HEAD OFFICE.	
		ORDINARY POSTAGE	WITH 3d. EXTRA STAMP
Bewdley, Stourport, Cleobury Mortimer, Kidder. & District..		4.30 a.m.	
Birmingham and General .. .. .		8.0 "	
Town Delivery .. .. .		9.0 "	
Shropshire and Central Wales .. .. .		10.0 "	
Birmingham and General .. .. .	10.45 a.m.	11.10 "	11.15 a.m.
Dudley, Stourbridge, and Brierley Hill .. .. .		11.40 "	
Worcester .. .. .		12.30 p.m.	
Wolverhampton .. .. .		1.0 "	
Bewdley, Cleobury Mortimer, Stourport, and Town Delivery..	1.0 p.m.	1.30 "	1.35 p.m.
Birmingham, Dudley, Gloucester, Leamington, Malvern, Stourbridge, Brierley Hill, Walsall, Warwick, Wolverhampton, and Worcester .. .. .		2.10 "	
Town Delivery .. .. .		7.0 "	
General Night Mail .. .. .		7.40 "	7.45 "
West of England and South Wales .. .. .		8.15 "	8.20 "
Birkenhead, Buxton, Chester, Crewe, Eccleshall, Liverpool, Manchester, Middlewich, Rugeley, Stafford, Stone (Staffs.), Sandbach, Stockport, Wolverhampton, North and Central Wales... .. .	9.0 "	9.15 "	9.20 "
Birmingham, London, and South Midland Counties ...)			

### DELIVERIES—WEEK DAYS.

	DELIVERY COMMENCES	
London and ALL PARTS .. .. .	At ..	7.0 a.m.
Birmingham, London, South of England and Ireland .. .. .	.. ..	9.15 "
Birmingham, London, Midland Counties & West of England .. .. .	.. ..	2.0 p.m.
Birmingham, London, Midland Counties and the North .. .. .	.. ..	7.40 "

### SUNDAYS.

On Sundays there is one General Despatch .. .. . At 7.40 p.m.  
And one Delivery commencing at 7 a.m. The Office is open for Registering Letters, the Sale of Stamps and for Telegraph business from 7.0 to 10 a.m.

### POSTAL TELEGRAPH OFFICE.

Open from 7 a.m. to 9 p.m. on Week Days, and from 7 a.m. to 10 a.m. on Sundays.

### PARCEL POST.

The Office is open for Parcel Post business from 7.0 a.m. to 10 p.m. on Week Days.  
No Parcel Post business is transacted on Sundays.

### DELIVERIES.

PARCEL Deliveries	7.0 a.m.
commence at	9.15 "
	2.0 p.m.
	7.40 "

### DESPATCHES.

Parcels are despatched to ALL PARTS ..	9.30 a.m.
Brierley Hill and Stourbridge .. .. .	11.30 "
Worcester .. .. .	12.10 p.m.
Bewdley, Cleobury Mortimer and Stourport ..	1.30 "
ALL PARTS .. .. .	1.45 "
	7.30 "
Bewdley and Stourport .. .. .	9.0 "

OVER.

## Kidderminster Post Office.

MONEY ORDER, SAVINGS BANK, ANNUITY  
AND INSURANCE BUSINESS.

	From	To
Money Orders are issued and paid, Savings Bank, Government Annuity, and Insurance business transacted, and Inland Revenue Licenses Issued ... ..	9.0 a.m.	6.0 p.m.
On Saturdays ... ..	9.0 "	8.0 "
POSTAL ORDERS are {	Issued ... ..	7.0 "
	Paid ... ..	9.0 "
		10.0 "

No Business of this description transacted on Sundays,  
Christmas Day, or Good Friday.

APPLICATIONS FOR THE RETURN OF  
LETTERS.

A Letter when once posted cannot be returned to the writer except through the Returned Letter office (this rule applies equally to a Parcel). Letters or Parcels for Addresses in the Town cannot be handed over at the Counter. They must be delivered by the Postman as addressed.

## CHANGE AND BAD MONEY.

No Postmaster is bound to give change, or is authorized to demand change; and when any money is paid at this Office, whether as change or otherwise, no question as to the right amount, goodness, or weight, can be entertained after it has been removed from the Counter.

## POST OFFICE GUIDE.

Full information on Post Office subjects generally, including Rates of Postage, &c., is given in the Post Office Guide, which can be procured at this Office, price Sixpence.

## Carriers from Kidderminster

TO

- Abberley and Witley—JNO. BOWEN, from Royal Exchange, Thursday, 3 p.m., and Saturday.  
 Alveley—JENNINGS, from Fox Inn, Thursday; ELCOCK, from Fox Inn, Thursday, at 3 p.m.  
 Astley—HODGES, from Royal Exchange. Thursday, at 3 p.m.  
 Astley Burf—CRUMP, from Corn Exchange, Thursday.  
 Bayton—LEWIS, from Fox Inn, Thursday, 2 p.m.; DUNN, from Bull Inn, Thursday.  
 Bewdley and Rock—REECE, from Grapes Inn, Thursday; HADLAND, from Grapes Inn, Thursday; Mrs. DAVIES, from Worcester Cross Inn, Thursday.  
 Blakedown and Brierley Hill—BROOKS, from Fox Inn, Thursday, 12-30 p.m.  
 Chaddesley—JAS. HILL, from Worcester Cross Inn, Thursday, 2 p.m.; GRIFFIN, from Coffee Tavern, Thursday.  
 Cookley & Kinver—WELCH, from Black Star, Thursday.  
 Holt—ROBERTS, from Wheat Sheaf, Thursday.  
 Kinlet—MOULE, from Bull Inn, Thursday.  
 Orton—SAYCE, from Bull Inn, Thursday.  
 Pensax—HAYES, from Bull Inn, Thursday.  
 Shatterford—WALFORD, from Fox Inn, Thursday; EDWARDS, George and Dragon, Thursday.  
 Stourport—PUGH, Newtown, Stourport, daily (dray collects goods); HODGETTS, from Half Moon Inn, Thursday; LITTLFORD, from Bull Inn, Thursday.  
 Stourport and Bewdley—*See also Omnibus Guide.*
- Any Carrier omitted from List, to communicate with the Printer.

—  —

THE END OF GUIDE

(*Prepared by* ED. BROADFIELD, *Postmaster*),

*To which is added a Directory of Kidderminster, with a view to increase its usefulness.*



THE PARISH CHURCH

*(St. Mary and All Saints, Kidderminster).*



# KIDDERMINSTER DIRECTORY,

WITH A LIST OF

MEMBERS OF THE CORPORATION ; COUNTY COUNCILLORS ;  
PUBLIC OFFICERS.



BOROUGH AND COUNTY JUSTICES ; BOARD OF GUARDIANS ;  
BURIAL BOARD ; SCHOOL BOARD ;  
GRAMMAR SCHOOL GOVERNORS ; PLACES OF WORSHIP.



STATISTICS OF THE BOROUGH.



PUBLIC INSTITUTIONS ; SCHOOLS ; FRIENDLY SOCIETIES.



RESIDENTS AND TRADESMEN,

ETC., ETC.

## Corporation of Kidderminster, 1889.

### LIST OF ALDERMEN AND COUNCILLORS, WITH THE DATES OF ELECTION.

*Aldermen Elected 9th November,  
1883.*

William Coxon,  
William Clement Green,  
William Howe Green.

*Elected 9th November,  
1886.*

William Henry Anderson  
William Alfred Crowther  
George William Grosvenor

#### *Councillors.*

NO. 1—ST. MARY'S WARD.

*Elected.*

1886—J. W. Consterdine-  
Chadwick.  
1887—William Hooper.  
1888—Joseph Ray.

NO. 2—BAXTER WARD.

*Elected.*

1886—Thomas Stone.  
1887—James Brazier.  
1888—Hy. Richard Willis

NO. 3—ST. GEORGE'S  
WARD.

*Elected*

1886—Henry Herring  
1887—George Rollings  
1888—Henry Bennett

NO. 4—ROWLAND HILL  
WARD.

*Elected*

1886—John Bytheway  
1887—Michael Tomkinson  
1888—J. Lionel Stretton

NO. 5—PARK WARD.

*Elected*

1886—Thomas Tempest-  
Radford  
1887—J. Harold Watson  
1888—Edmond Potter.

NO 6—ST. JOHN'S WARD,

*Elected*

1886—George Holloway  
1887—Edwd. J. Morton  
1888—Daniel Wagstaff  
Goodwin

### Member of Parliament.

AUGUSTUS FREDERICK GODSON, ESQ.

## County Councillors.

### KIDDERMINSTER ELECTORAL DIVISIONS.

		No. of Votes Received.	No. of Voters in Division.
<i>North</i> (No. 1).	T. Tempest-Radford	444	1218
<i>East</i> (No. 2).	G. W. Grosvenor	513	1133
<i>South</i> (No. 3).	M. Tomkinson (unopposed)		1119
<i>West</i> (No. 4).	D. W. Goodwin	489	1146
<i>Foreign</i>	W. C. Green	365	873
<i>Wolverley</i>	John Giles (unopposed)		832

First Election, January 24th, 1889. Members to serve 3 years.

### Public Officers.

High Steward—The Earl of Dudley  
Deputy Lieutenant—George W. Grosvenor  
High Constable—S. W. Laycock  
Chief Constable—E. Bennett  
Town Clerk—J. Morton.  
Borough Treasurer—W. Penny  
Borough Surveyor and Engineer—A. Comber  
Surveyor of Roads (Kidderminster District)—J. H. Garratt  
Medical Officer of Health—D. Corbet  
Sanitary Inspector (Borough)—J. T. Cowderoy. (Foreign),  
Charles Steadman.  
Curator of Town Hall—T. B. Beddoes.  
Inspector of Weights and Measures—E. Bennett  
Poor Rate Collectors and Assistant Overseers (Borough),  
R. Grove. (Foreign), John Grant.  
Collector of Rates to Town Council—E. Guest  
Borough Accountant—T. H. Williams  
Borough Organist—W. Taylor, Mus. Bac., Oxon.  
Supervisor, Inland Revenue—John Lloyd.  
Surveyor of Queen's Taxes—Owen Cook  
Superintendent Registrar of Births, Marriages, and Deaths—  
F. Burcher  
Registrars of Marriages—Thomas Milnes and John Cooksey  
Registrar of Births and Deaths—George Friend  
Vaccination Inspector—Thomas Wallis  
Public Vaccinator—H. E. Langford



## Kidderminster Borough Justices.

*Mayor.*

EDWARD JAMES MORTON.

*Deputy-Mayor.*

MICHAEL TOMKINSON.

William Henry Anderson	Daniel Wagstaff Goodwin
Thomas Banks	William Clement Green
John Brinton	James Joseph Harvey
William Boycott,	Joseph Naylor
William Coxen	Thomas Tempest-Radford
Henry Dixon	Samuel Stretton
Samuel Fawcett	Samuel Tovey(W'hampton)

*Magistrates' Clerk*—FREDERICK BURCHER.

Borough Bench every Monday, Wednesday, and Friday, at 11 a.m.

## County Justices.

*(Kidderminster Division).*

John Brinton	Sir F. W. Knight, K.C.B.
Frederick Elkington	Thomas Lea, M.P.
John Giles	Edward James Morton
Daniel Wagstaff Goodwin	H. D. Wakeman-Newport
Henry Howard	Major De Trafford
Major Hancock	Robert Woodward

*Justices' Clerk*—FREDERICK BURCHER.

County Petty Sessions every other Thursday, at 11 a.m.

*Allowance to Witnesses in Criminal Cases before Committing Justices.*

Professional witnesses, to give professional evidence, not more than £1 is per day, and mileage not to exceed 3d. per mile each way. Other witnesses, 1s. to 3s. 6d. per day, and second class railway fare each way.

At Quarter Sessions or Assizes the same.

## Board of Guardians.

Consisting of 13 Ex-Officios and 25 Elected Members.

(For Ex-Officios, see County Justices).

*Chairman*—John Brinton.

Leonard Arthur Gabb	George Rollings
Robert Robins Harcombe	Thomas S. Bucknall
Walter H. Hickman	James J. Harvey
Frank Corbett	William Hartland
John Page	Thomas Bond Worth
William Trow	James Mytton
John Marshall Downing	Edward H. Winnington-Ingram
William Boycott	William Lett
William Hooper	Richard Brewster
William C. Awdry	Sampson H. Hobbs
Josiah Peart Harvey	Arthur E. Boucher
George Richard Green	Thomas Pitt
Henry Bennett	

Medical Officers—North Ward : Henry Edward Langford, M.D. South Ward : S. Stretton

Meeting every alternate Tuesday, at the Board Room Union Workhouse, at 11.

Clerk—Frederick Burcher. Relieving Officers—No. 1 District : Thomas Wallis, Findon street. No. 2 District : William Young, Sutton road. Assistant ditto for Tramps : E. Bennett, Police Station. Collector—Thomas Blankley Beddoes.

The Poor Law Union comprises the following Parishes : Bewdley, Broom, Chaddesley Corbett, Churchill, Dowles, Kidderminster (Borough and Foreign), Lower Mitton, Ribbesford, Rushock, Stone, Upper Arley, and Wolverley.

Union Workhouse — Master : Thomas H. Hope. Matron—Mrs. Hope. Assistant Matron—Annie Wilkinson. School Mistress—Miss Atkin. Chaplain—Rev. Sidney Phillips. Surgeon—S. Stretton.

**School Board.**

Triennial Election :  
April, 1886

Next Election :  
April, 1889.

*President* :—E. Parry.

*Members* :

G. Holdsworth	Rev. S. Phillips
G. Holloway	T. Stone
Jno. Killingbeck	A. S. Thursfield
E. J. Morton	Rev. C. A. Wheatley

**Burial Board.**

*Chairman* :—The Rev. Sidney Phillips.

Henry Herring	C. W. Cotching
R. Talbot Watson	William Hooper
Edward Parry	Thomas Brown
Thomas James	John Bytheway

*Clerk* :—Thos. F. Ivens.      *Superintendent* :—E. Randall.

**Grammar School Governors.**

King Charles the First's School, Kidderminster.

*Chairman* :—The Rev. Sidney Phillips.

*Vice-Chairman* :—G. W. Grosvenor.

W. Boycott	John Brinton
D. W. Goodwin	W. H. Talbot
E. J. Morton	Thomas Lea, M.P.
E. Parry	Thomas Tempest-Radford
Robert Woodward	M. Tomkinson

*Head Master* :—The Rev. J. R. Burton.

*Clerk* :—Thomas F. Ivens.

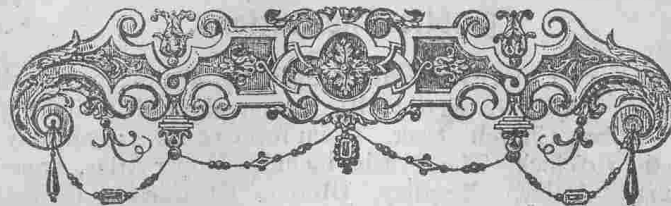
**School of Art and Science**

(Established 1862).

Situated in Market Street and Exchange Street.

*President*—The Earl of Dudley.

*Vice-Presidents*—Sir E. A. H. Lechmere, Bart., M.P.,  
The Mayor of Kidderminster.

*Chairman*—John Brinton, J.P.

*Vice-Chairman*—G. W. Grosvenor, J.P., D.L.

**Art Department**—Head Master : William Tucker (qualified Art and Science), Teacher. 2nd. Master—C. E. Flowerdew (certificated for Art). Assistant Teacher—Miss M. Heys.

**COURSES OF INSTRUCTION.**—Mechanical Drawing (including Practical Geometry, Perspective, Architecture, Building Construction, and Machine Drawing), Ornamental Drawing, Figure Drawing, Painting in Oil and Water Colours, Modelling and Casting in Plaster of Paris.

**Science Department**—Head Master : W. Ray, F.C.S., F.I.C., assisted by five qualified Teachers.

In connection with the above, there is a fully equipped Laboratory for the purpose of Analysing Dyewares, &c.

**The Art Gallery and Exhibition**

Is open every Saturday, from 2 till 9, and consists of Art and Industrial Objects, Students' Works, etc., etc.

## Public Institutions.

COUNTY COURT.—Meetings Monthly, at the Town Hall, Judge, Rupert A. Kettle; Registrar and High Bailiff, W. H. Talbot, Church Street. Open from 10 till 4; Saturdays, 10 till 1 o'clock. The District includes Upper Arley, Areley Kings, Astley, Bewdley, Broom, Chaddesley Corbett, Churchill, Dunley, Hartlebury, Lower Mitton, Upper Mitton, Ribbesford, Rushock, Stone, Stourport, Wolverley and Dowles.

GAS COMPANY—Works and Offices, Pitt's Lane—Manager, Andrew Dougall; Secretary, Charles Grant; Collector, James Penny.

THE INFIRMARY AND CHILDREN'S HOSPITAL, Mill St.—President, Rev. Sidney Phillips, M.A.; Vice-President, The Right Rev. the Lord Bishop of Worcester; Treasurers, The Birmingham Banking Company, Ltd.; Hon. Auditor, John Stooke; Consulting Physician, Sir B.W. Foster, M.D.; Consulting Surgeon, Samuel Stretton; Dental Surgeon, C. H. Clifford Batten; Hon. Surgeons, Messrs. E. H. Addenbrooke, W. Moore, J. Lionel Stretton, and Dr. Preston; Secretary, James Chambers; House Surgeon, John Rust; Matron, Mrs. Phillips.

FREE LENDING LIBRARY AND NEWS ROOM, Vicar Street—open from 10 till 9; Librarian, Alfred Penny.

CORPORATION BATHS AND WASH-HOUSES, Mill Street—Superintendent, W. Freeman; Matron, Mrs. Freeman; open from 6 till 9. Turkish Baths adjoining; open from 10 till 8.

RETAIL MARKET, High Street; Thursdays and Saturdays. WHOLESALE (Thursdays) and CATTLE MARKET (Tuesdays), in Market Street; Superintendent, L. Fawke.

GREAT WESTERN RAILWAY.—Station Master (Passenger), J. B. Mayers; Goods Agent, S. P. Hunt.

GENERAL POST OFFICE, Exchange Street. (See page 39 and 40).

SCHOOL OF ART AND SCIENCE, Market Street and Exchange Street—(see page 49). A Permanent Art Gallery with a Collection of Art and Industrial Objects is open on Saturdays from 2 till 9.

TOWN HALL AND CORN EXCHANGE, Vicar Street—Curator, T. B. Beddoes.

THE BRINTON PARK—Entrance Stourport Road; open daily. Park-keeper, W. Tandy.

WATER AND SEWAGE WORKS—Pumping Stations, Green Street and Stourport Road; Resident Engineer, J. Fredericks.

STAMP OFFICE, High Street—Distributor, Thomas Mark.

INCOME TAX OFFICE, High Street.

WORCESTERSHIRE AND STAFFORDSHIRE CANAL COMPANY—Keeper, C. Birch, Mill Street.

## Places of Worship and Ministers:

### *Times of Services.*

ST. MARY'S CHURCH, (The Parish Church)—Vicar, Rev. S. Phillips, M.A.; Curates, Rev. R. E. Spencer, Rev. E. R. Burroughs, M.A., Rev. O. A. Moore, B.A., Rev. E. A. Ferguson, B.A.; Churchwardens (Borough) Messrs. F. Burcher, W. C. Awdry, (Foreign) Messrs. M. Tomkinson, I. Hampton; Organist, W. Taylor, Mus. Bac., Oxon. Services, Sundays—Holy Communion at 8 a.m.; Morning Prayer at 11 a.m.; Children's Service at 3.15 p.m.; Evensong and Sermon at 6.30; Holy Communion first Sunday in the month at 7 and 8 a.m.; first and third Sundays at 11.45 a.m.; second, fourth, and fifth Sundays at 8 a.m. Week Days—Holy Communion (Thursdays) at 8 a.m.; Matins (except Wednesdays and Fridays) at 10 a.m.; Wednesdays and Fridays, Matins and Litany, at 11 a.m.; Evensong (Wednesdays at 5 p.m.) other days at 7.30 p.m.

## Public Institutions.

COUNTY COURT.—Meetings Monthly, at the Town Hall, Judge, Rupert A. Kettle; Registrar and High Bailiff, W. H. Talbot, Church Street. Open from 10 till 4; Saturdays, 10 till 1 o'clock. The District includes Upper Arley, Areley Kings, Astley, Bewdley, Broom, Chaddesley Corbett, Churchill, Dunley, Hartlebury, Lower Mitton, Upper Mitton, Ribbesford, Rushock, Stone, Stourport, Wolverley and Dowles.

GAS COMPANY—Works and Offices, Pitt's Lane—Manager, Andrew Dougall; Secretary, Charles Grant; Collector, James Penny.

THE INFIRMARY AND CHILDREN'S HOSPITAL, Mill St.—President, Rev. Sidney Phillips, M.A.; Vice-President, The Right Rev. the Lord Bishop of Worcester; Treasurers, The Birmingham Banking Company, Ltd.; Hon. Auditor, John Stooke; Consulting Physician, Sir B.W. Foster, M.D.; Consulting Surgeon, Samuel Stretton; Dental Surgeon, C. H. Clifford Batten; Hon. Surgeons, Messrs. E. H. Addenbrooke, W. Moore, J. Lionel Stretton, and Dr. Preston; Secretary, James Chambers; House Surgeon, John Rust; Matron, Mrs. Phillips.

FREE LENDING LIBRARY AND NEWS ROOM, Vicar Street—open from 10 till 9; Librarian, Alfred Penny.

CORPORATION BATHS AND WASH-HOUSES, Mill Street—Superintendent, W. Freeman; Matron, Mrs. Freeman; open from 6 till 9. Turkish Baths adjoining; open from 10 till 8.

RETAIL MARKET, High Street; Thursdays and Saturdays. WHOLESALE (Thursdays) and CATTLE MARKET (Tuesdays), in Market Street; Superintendent, L. Fawke.

GREAT WESTERN RAILWAY.—Station Master (Passenger), J. B. Mayers; Goods Agent, S. P. Hunt.

GENERAL POST OFFICE, Exchange Street. (See page 39 and 40).

SCHOOL OF ART AND SCIENCE, Market Street and Exchange Street—(see page 49). A Permanent Art Gallery with a Collection of Art and Industrial Objects is open on Saturdays from 2 till 9.

TOWN HALL AND CORN EXCHANGE, Vicar Street—Curator, T. B. Beddoes.

THE BRINTON PARK—Entrance Stourport Road; open daily. Park-keeper, W. Tandy.

WATER AND SEWAGE WORKS—Pumping Stations, Green Street and Stourport Road; Resident Engineer, J. Fredericks.

STAMP OFFICE, High Street—Distributor, Thomas Mark.

INCOME TAX OFFICE, High Street.

WORCESTERSHIRE AND STAFFORDSHIRE CANAL COMPANY—Keeper, C. Birch, Mill Street.

## Places of Worship and Ministers:

### *Times of Services.*

ST. MARY'S CHURCH, (The Parish Church)—Vicar, Rev. S. Phillips, M.A.; Curates, Rev. R. E. Spencer, Rev. E. R. Burroughs, M.A., Rev. O. A. Moore, B.A., Rev. E. A. Ferguson, B.A.; Churchwardens (Borough) Messrs. F. Burcher, W. C. Awdry, (Foreign) Messrs. M. Tomkinson, I. Hampton; Organist, W. Taylor, Mus. Bac., Oxon. Services, Sundays—Holy Communion at 8 a.m.; Morning Prayer at 11 a.m.; Children's Service at 3.15 p.m.; Evensong and Sermon at 6.30; Holy Communion first Sunday in the month at 7 and 8 a.m.; first and third Sundays at 11.45 a.m.; second, fourth, and fifth Sundays at 8 a.m. Week Days—Holy Communion (Thursdays) at 8 a.m.; Matins (except Wednesdays and Fridays) at 10 a.m.; Wednesdays and Fridays, Matins and Litany, at 11 a.m.; Evensong (Wednesdays at 5 p.m.) other days at 7.30 p.m.



ST. GEORGE'S PARISH CHURCH—Vicar, Rev. Theobald W. Church, M.A.; Curates, Rev. W. F. Shillito, B.A., Rev. C. E. Newcomb, B.A., Rev. E. J. Bartleet, B.A.; Churchwardens, Messrs. T. Wallis, J. F. H. Saunders; Organist, Mr. J. Fitzgerald. Services, Sundays—Holy Communion at 8 a.m.; Morning Prayer at 11 a.m.; Children's Service at 3 p.m.; Evensong and Sermon at 6.30; Holy Communion first Sunday in the month at 7 and 8 a.m.; first and third Sundays at 11 a.m. Week Days—Morning Prayer at 10 a.m.; Wednesdays and Fridays, with Litany, at 11 a.m.; Evensong, daily, with Sermon on Wednesdays at 7.30 p.m.

ST. JOHN'S PARISH CHURCH—Vicar, Rev. J. F. Kershaw, M.A.; Curates, Rev. L. H. Outram, B.A., Rev. C. A. Furnival, B.A.; Churchwardens, Messrs. D. W. Goodwin, James Morton; Organist, W. E. Wadely, F.C.O. Services, Sundays—Holy Communion at 8 a.m.; Morning Prayer at 10.30 a.m.; Evening Prayer at 6.30; Holy Communion first and third Sundays in the month after Morning Prayer. Week Days—Morning Prayer at 10 a.m.; Evensong at 7.30 p.m.

HOLY TRINITY CHURCH—Trimpley (Chapel of Ease of St. Mary's); Deputy Churchwarden, Mr. J. Chellingworth; Organist, Miss A. Chellingworth. Services, Sundays—11 a.m. Holy Communion first Sunday in the month.

ST. BARNABAS' CHURCH, FRANCHE (Chapel of Ease of St. Mary's)—Curate, Rev. C. Stockdale; Deputy Churchwarden, Mr. M. Tomkinson; Organist, Mr. R. Grove, jun. Services, Sundays—Morning Prayer at 11 a.m.; Evening Prayer at 6.30 p.m.; Holy Communion first, third and fifth Sundays at 11 a.m.; second and fourth Sundays at 8 a.m.; Saints' Days and Holy Days—Holy Communion at 8 a.m.; Evening Prayer at 7.30 p.m.

ST. JAMES' CHURCH (Chapel of Ease of St. Mary's)—Curate, Rev. R. E. Spencer; Churchwardens, Messrs. L. V. Bishop and A. J. Ledwith. Services, Sundays—Morning Prayer at 11 a.m.; Evening Prayer at 6.30 p.m.;

Holy Communion second and fourth Sundays in the month at 8 a.m.; on the third Sundays at 7 a.m. Week Days—Wednesdays Evensong at 7.30 p.m.

ST. STEPHEN'S MISSION CHAPEL, Mill Street (Parish of St. John Baptist). Services, Sundays—Children's Service, 10.30, Evening Service 6.30; Week Days—Wednesdays Evening Service 7.30; Holy Communion at 8 a.m. on the first Sunday in the month

HOLY INNOCENTS' MISSION CHAPEL, Foley Park (Parish of St. John Baptist). Services, Sundays—11 a.m. Children's Service 10.45, Evening Service 6.30; Week Days—Wednesday Evening Service 7.30; Holy Communion at 8 a.m. on second Sunday in the month.

ST. AMBROSE'S CHURCH (Roman Catholic) LESWELL—Priest in charge, Rev. C. A. Wheatley; Curate, Rev. C. Riordan. Services, Sundays—8.30 a.m., 11 a.m., 4 p.m., 6.30 p.m.; Week Days—Morning Mass 8.30, Thursdays Benediction, 7.30 p.m.

BAXTER CHURCH (Congregational)—Minister, Rev. F. H. Blanchford; Assistant Minister, Rev. E. Davenport, Stourport; Town Missionary, Mr. S. Rothera; Treasurer, Mr. T. Banks; Secretary, Mr. T. Thomson; Deacons, Messrs. W. Adams, T. Banks, James T. Johnson, Thomas Lea, M.P., Thomas McCandless, George W. Naylor, Thomas F. Naylor, Edward Smith, Thomas Thomson; Organist and Choirmaster, J. T. Johnson. Services, Sundays—10.30 a.m. and 6.30; Week Days—Wednesdays 7 p.m.

BAPTIST CONGREGATIONAL CHURCH, Church Street—Minister, Rev. T. Fisk; Deacons, E. Lythall, William Price, Saywin Lucas, J. P. Harvey, H. Poole, H. M. Bell; Organist, Mrs. Bradshaw. Services, Sundays—Prayer Meeting 7 a.m., 10.30 a.m., and 6.30 p.m.; Week Days—Wednesdays and Saturdays at 7 p.m.

WESLEYAN CHAPEL, Mill Street—Minister, Rev. Simpson Crump; Society Stewards, Messrs. Cowpe and

Tyler; Chapel Steward, Messrs. J. B. Mayers and H. Cowpe; Treasurer, Mr. George Holdsworth; Organist, Mr. D. L. Mitchell; Services, Sundays—10.30 a.m. and 6.30 p.m., Class Meetings 3 p.m.; and Good Friday and Christmas Day; Week Days—Mondays and Wednesdays 7.30 p.m., Thursdays 7 p.m.

NEW MEETING HOUSE, Church Street—Minister Rev. James Hall; Treasurer, Mr. George Hopkins; Organist, Miss C. Badland; Wardens, Messrs. Hodgson and Brooke; Auditor, Mr. A. Cowell; Treasurer of Day Schools Mr. John Stooke; Sunday Schools, Miss Parkes; Chapel Keeper, Mrs. Harrison. Services—Sundays, 10.30 a.m. and 6.30 p.m.; Week Days—Wednesdays 7.30 p.m.

COUNTESS OF HUNTINGDON'S CHAPEL—Pastor, The Rev. W. Clayton Fuidge; Organist—Mr. John Barlow; Superintendent of Sunday School, Mr. James Jones. Services, Sundays—10.30 a.m. and 6.30 p.m.; Week Days—Wednesdays at 7 p.m.

PRIMITIVE METHODIST CHAPEL, Cross Street—Minister, Rev. Thomas Pigott; Treasurer, Mr. W. Bennett; Secretary, Mr. S. Broadhurst. Services, Sundays, 10.45 a.m. and 6 p.m.

CHRISTADELPHIAN MEETING ROOM, CO-OPERATIVE HALL, Worcester Street—Sundays—Meeting for Breaking of Bread 10.30 a.m., Sunday School 2.30 p.m., Public Lecture 6.30 p.m.; Week Days—Thursdays Public Bible Class 7.30 p.m.

CATHOLIC APOSTOLIC MEETING ROOM, Oxford Street—Public Services—Sundays, 10.30 a.m., 5.30 p.m.—Week Days—Thursdays 7 p.m., Saturdays 5.30 p.m.

SALVATION ARMY HALL, Stourbridge Street.

### Society of Church Bell-Ringers.

This Society was started a short time ago for the practice of Change-Ringing. President, The Vicar; Secretary, John Crane. Practice every Wednesday evening (except in Lent).

### Kidderminster Volunteers.

3 Companies belonging to 1st. Volunteer Battalion  
Worcestershire Regiment.

Col. Commanding—Col. Sir F. Winn-Knight, K.C.B., Wolverley; Col. W. H. Talbot, Whitville; Lt. Col. R. T. Watson, Honeybrook; Major A. N. Adams (Adjutant), Blakebrook; Quarter-Master A. Comber, Chester road.

**C** Company—Major, J. Morton; Lieut., J. Mossop; Sergeant-Inst., Cope.

**D** Company—Major, J. R. Goodwin; Lieut., H. J. Dixon; 2nd. Lieut., C. A. C. Batten; Sergeant-Inst., Thomas Webster.

**L** Company—Capt., John Watson; Lieut., A. S. Thursfield; Sergeant-Inst., Charles Feaver.

THE BAND OF THE BATTALION (Brass and Reed) consists of 21 members; Bandmaster, A. Taylor; Leader, C. Osborne.

### Statistics of the Borough.

Area of Municipal Borough	...	1213 Acres.		
		1871.	1881.	
Population of Municipal Borough	...	19,473	24,270	
"    Parliamentary Borough	...	20,814	25,634	
Rateable Value (Borough)	...	£ 70,130	s. 14	d. 0
"    "    (Foreign)	...	6,759	3	0
		<hr/>		
		76,889	17	0
Assessable Value (Borough)	...	57,099	11	0
"    "    (Foreign)	...	5,321	19	6
		<hr/>		
		62,421	10	6
rd. in the £ produces	...	£260	1	10

Number of Voters in County Council Divisions (*See page 45*).

Number of Parliamentary Voters ... .. 4211

Number of Municipal Voters, 1888—

No. 1.—St. Mary's Ward	...	...	...	814
„ 2.—Baxter Ward	...	...	...	802
„ 3.—St. George's Ward	...	...	...	737
„ 4.—Rowland Hill Ward	...	...	...	892
„ 5.—Park Ward	...	...	...	688
„ 6.—St. John's Ward	...	...	...	682

4615

Present General District Rates, 2/6 in the £

„ Poor Rate (Borough),	2/-	„
„ „ (Foreign),	2/-	„

### Health of the Borough.

*Comparative Table of Ten Towns in the Midland Counties.*

	1887.	1888.
	<i>Death Rate per 1000.</i>	
Cheltenham	...	18·2
Shrewsbury	...	18·4
Stoke-upon-Trent	...	20·8
Walsall	...	18·2
<b>Kidderminster</b>	...	<b>16·92</b>
Dudley	...	19·6
Worcester	...	21·8
Coventry	...	17·5
Birmingham	...	21·03
Wolverhampton	...	22·34

The Registrar's Returns of other Towns for 1888 are not yet published.

## Masonic Lodges, Friendly Societies, &c.

Antient and  
Honourable  
Fraternity

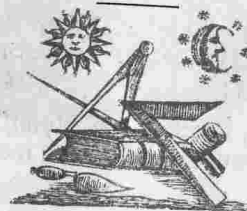

of Free and  
Accepted  
Masons.

LODGE "HOPE AND CHARITY," No. 377, Masonic Hall, Kidderminster. W.M., 1889, D. Mackay.

LODGE "LECHMERE," No. 1874, Masonic Hall, Kidderminster. W.M., 1889, G. R. Green.

"HOPE AND CHARITY" CHAPTER, No. 377, Royal Arch Masons. M.E.Z., W. M. Roden.

"GODSON" LODGE, No. 330. Mark Masters. W.M., H. B. Pigot.

Independent  
Order of  
Oddfellows,



Manchester  
Unity.

*District Officers' names and addresses, 1889:—*

Prov. G.M., James T. Hill, 87 Mill St; Prov. D.G.M., James Brazier, Churchfields; Prov. C.S., Benjamin Beach, Chester road; Treasurer, John Bytheway, Station Hill; Relieving and Examining Officer, Thomas Brooke, Pitt's Lane. Registered District Office, 7 Chester Road.

*Lodges in the Borough of Kidderminster with Permanent Secretary's name, address, &c.*

'King William IV' Lodge, Foley Arms Inn, Cross St. Secretary, Benjamin Hooper, 71 Lorne Street. 69 members; amount of funds £348.

'Victoria' Lodge, Black Horse Hotel, Mill St. Secretary, James Coates, Avenue Road. 172 members; amount of funds £1938.

\* 'Lord Ward' Lodge, Coach and Horses Inn, Mill St. Secretary, Edwin Hanson, Offmore Road. 120 members; amount of funds £505.

'Lord Hill' Lodge, Grapes Hotel, Worcester Street. Secretary, Thomas H. Horton, Franche Road. 210 members; amount of funds £1024.

'Franche' Lodge, Corn Exchange Hotel, New Road. Secretary, Philip Felton, Horsefair. 158 members; amount of funds £687.

'Sir Rowland Hill' Lodge, Anchor Hotel, Oxford St. Secretary, Alfred Peacock, 16 Stourbridge St. 107 members; amount of funds £323.

'John Bytheway' Lodge, Rock Vaults, Park Butts. Secretary, Thomas Reynolds, 77 Crescent Road. 21 members; amount of funds £35.

'Richard Baxter' Lodge, Oddfellows' Room, High St. Secretary, William Bune, Hurcott Road. 16 members; amount of funds £24.

'Past Grands' Lodge, Seven Stars' Inn, Coventry Street. Secretary, Thomas H. Horton, Franche Road. 49 members; amount of funds £106.

'Pride of District' Juvenile Lodge, Oddfellows' Room, High St. Secretary, Benjamin Hooper, 71 Lorne St. 189 members; amount of funds £163.

\* At the time of printing, it is likely that there will be a change in the abode of the "Lord Ward" Lodge. B. BEACH.

Ancient  
Order



of  
Foresters.

*Names and addresses of District Officers.*

District Chief Ranger—G. Williams, Duke of York Inn, Churchfields. District Sub-Chief Ranger—S. Smith, Surveyor, Cleobury. District Treasurer—H. Carter, Lorne Street. District Secretary—S. Taylor, 3, Stourbridge Street.

Court "Providence," No. 2520, Half Moon Inn, New Road, Nights of Meeting, alternate Mondays. No. of Members, 230; amount of funds £2500. Secretary—W. Yates, Land Oak Cottages; Treasurer—E. Silk, Boulter's Lane.

Court "Royal Oak," No. 2521, Hen and Chickens' Inn, Mill Street. Nights of Meeting, every fourth Monday. No. of Members 180; amount of funds £1700. Secretary—C. Grant, Roden Avenue; Treasurer—S. Taylor, 3, Stourbridge Street.

Court "Wolverley," No. 4502, Hare and Hounds, Broadwaters. Nights of Meeting, every fourth Monday. No. of Members—86; amount of funds £660. Secretary—J. Tolley, Hurcott; Treasurer—J. Parker, 94, Wood Street.

Court "Perseverance," No. 4563, Royal Oak, George Street. Nights of Meeting, alternate Mondays. No. of Members 156; amount of funds £630. Secretary—W. Harris, 10 Villers Street; Treasurer—J. Prince, Royal Oak, George Street.

Court "Sympathy," No. 4905, Harp Inn, Horsefair, Nights of Meeting, alternate Mondays. No. of Members, 66; amount of funds £340. Secretary—T. Grove, 52 Park Street; Treasurer—W. Hankin, Coventry Street.



Court "Victoria," The Cross Inn, Station Hill. Nights of Meeting, alternate Mondays. No. of Members, 80; amount of funds £420. Secretary—J. Palmer, May Cottage, Woodfield; Treasurer—C Wakeman, Proud Cross.

Court "Woodfield," No. 6363, Sportsman Inn, Wood Street. Nights of Meeting, alternate Wednesdays. No. of Members 36; amount of funds £170. Secretary—H. Perrins, 67, Leswell Lane; Treasurer—G. Rollings, Sportsman Inn, Wood Street.

No. of Members comprising the District 2250; amount of District Funeral fund £2660.

Number of Juvenile Foresters 189; amount of funds £82.

### Loyal Orange Institution.

District Masters, T. White, Comberton Terrace; District Secretary, G. W. Rogers, 24, Long Acre, Hurcott Road; District Treasurer, T. Poutney, 52, Wood Street.

"VICTORY" LODGE, Clarendon Hotel—1st Monday in May and every 4 weeks.

"BRUNSWICK" LODGE, "Royal George" Inn — 4th Saturday in May and every 4 weeks.

"JUBILEE" LODGE, Rock Vaults—3rd Friday in May and every 4 weeks.

CHURCH OF ENGLAND MUTUAL AID SOCIETY—President, Rev. Sidney Phillips; Vice-President, John Bytheway; Treasurer, James Ashcroft; Steward, W. J. Craddock; Secretary, R. Grove. 141 members; amount of funds £1566

POWER-LOOM CARPET WEAVERS' MUTUAL DEFENCE ASSOCIATION—Offices: 127, Mill Street. President, Henry Moule; Vice-President, W. Payne; Secretary, Alfred Coates; Assistant Secretary, Albert Sweetman. About 1350 members; Invested Funds £10,442 19 0.

BRANCH OF THE HEARTS OF OAK FRIENDLY SOCIETY. Secretary, Thos. Marshall, London; Head Office, 17 Charlotte Street.

MEDICAL AID ASSOCIATION—Surgery, Lion Street, President, John Killingbeck; Treasurer, E. Silk; Secretary; W. Holloway, Plimsoll Street; Medical Officers, W. W. Gibson and an Assistant. 4457 members.

NEW MEETING PROVIDENT SOCIETY held in Pearsall's Schoolroom; Treasurer, Wm. H. Talbot; Medical Officer, Dr. Langford; Steward, Thos. Payne.

LICENSED VICTUALLERS' FRIENDLY AND PROTECTION SOCIETY — President, Frederick Starr; Vice-President, Thomas Green; Treasurer, Joseph Arnold; Auditors, Joseph Payne and George Coates; District Secretary, Thos. Rowley (Stourport); General Secretary, Robert S. Wilson; 107 members.

BRANCH OF THE AMALGAMATED SOCIETY OF CARPENTERS AND JOINERS held at the Anchor Inn, Worcester Street; District Secretary, Hy. Allen, 50 Lorne Street; Referees, T. W. Pursey, 10 Dudley Street; 55 District Members. Balance of General Fund £33,667 17s. 7½d. General Offices, 95, Brunswick Street, Ardwick Green, Manchester.

BRANCH OF THE STEAM ENGINE MAKERS SOCIETY held at the Anchor Inn, Worcester Street; District Secretary, John K. Stanley, 61, Park Lane; General Office, Market Buildings, Thomas Street, Shude Hill, Manchester.

WOOLSTAPLERS' SOCIETY, held at the Hen and Chickens' Inn, Mill Street. President and Vice-President elected quarterly. Treasurer, George C. Foss; Secretary, William Colsey. Funds invested in the Worcester City and County Bank.

### Kidderminster Fire Brigade.

A. COMBER, Hon. Captain. H. BREAKSPERE, Superintendent.

Eleven Members.

## Musical



## Societies.

**INSTRUMENTAL SOCIETY** (Old Mechanics' Institute) High Street — Musical Conductor, W. E. Wadely, F.C.O.; Rehearsals, Thursdays, 7.30 to 9.15.

**HARMONIC SOCIETY**—Conductor, Mr. Everist; Secretary, Mr. Albert Pugh, Yew Tree Road; Rehearsals every Thursday in the season at 8 p.m. at the Parish Room, George Street. Subscriptions nominal.

**THE GLEE UNION** (Messrs. Geo. and F. Mountford, W. and G. Hibberd). Secretary, F. Mountford, Sutton Road.

## Recreation Clubs, &amp;c.

**KIDDERMINSTER CLUB**, Church Street. Curator, George Woodward.

**MASONIC CLUB**, 127, Mill Street. President, E. Hammond. Secretary, F. Larr.

**WORKMEN'S CLUB AND INSTITUTE**, Coventry Street. President, Frederick Burcher; Vice-President, Rev. J. F. Kershaw, M.A.; Treasurer, M. Tomkinson; Secretary, R. Grove; Curator, Thomas Evans.

**KIDDERMINSTER CRICKET CLUB**.—Ground, Chester Road. President, T. Lea, Esq., M.P.; Vice-Presidents, Rev. S. Phillips, M.A., A. F. Godson, M.P., T. F. Ivens, T. S. Bucknall, M. Tomkinson, J. H. Watson, J. Elgood, Geo. Taylor, W. C. Green; Capt.

1st Team, H. Wilkes; Sub-Captain, 2nd Team, Fred. Tandy; Treasurer, George Taylor; Joint Hon. Secretaries, F. Tandy and George Hibberd. Home matches are arranged for every Saturday afternoon during the Season.



**HARRIERS AND FOOTBALL CLUB**.—Ground, Aggboro'. Patrons, Lord Lyttelton, and John Brinton; Vice-Presidents, The Rev. S. Phillips, M.A., Rev. T. W. Church, M.A., A. F. Godson, M.P., T. Lea, M.P., T. F. Ivens, J. H. Watson, D. W. Goodwin, W. A. Crowther, C. Crowther, T. Tempest-Radford, T. S. Bucknall, E. J. Morton; Captain of Club, J. Pritchard; Treasurer, W. C. Awdry; Secretary, C. H. Jones, 141 Mill Street. 31 Honorary, 274 Ordinary Members. Home matches every Saturday afternoon during the Season.



**OLYMPIC FOOTBALL CLUB**.—Cricket Ground, Chester Road. Matches every Saturday from September to April. Patrons, T. Lea, M.P., A. F. Godson, M.P., Jno. Corbett, M.P.; President, George Taylor; Vice-Presidents, Rev. T. W. Church, M.A., W. H. Anderson, G. W. Grosvenor, A. Cowell, W. H. Smith, G. R. Green, E. J. Morton, J. E. Stone, G. Holdsworth, D. Mackay. 200 Members. Hon. Sec., J. Knowles, 101, Lea Street.

**WORCESTERSHIRE CAMERA CLUB**—Meeting at the School of Science, Kidderminster; President, M. Tomkinson; Vice-Presidents, A. Cowell and A. Comber; Secretary, W. Ray.

*There are numerous other Clubs and Societies in the town, of which the space at our disposal will not permit us to give particulars, and the persons interested will please pardon this omission.*

## Banking Companies.

**BIRMINGHAM BANKING COMPANY, LIMITED**, Church Street—Manager, Wm. Penny; Agents, Smith, Payne, and Smith, London.

**WORCESTER CITY AND COUNTY BANKING COMPANY, LIMITED**, Vicar Street—Manager, Alexander Dow; Agents, The London Joint Stock Bank, Limited.

**BIRMINGHAM, DUDLEY AND DISTRICT BANKING COMPANY, LIMITED**, Oxford Street—Manager, W. C. Awdry; Agents, Williams, Deacon, & Co., London.

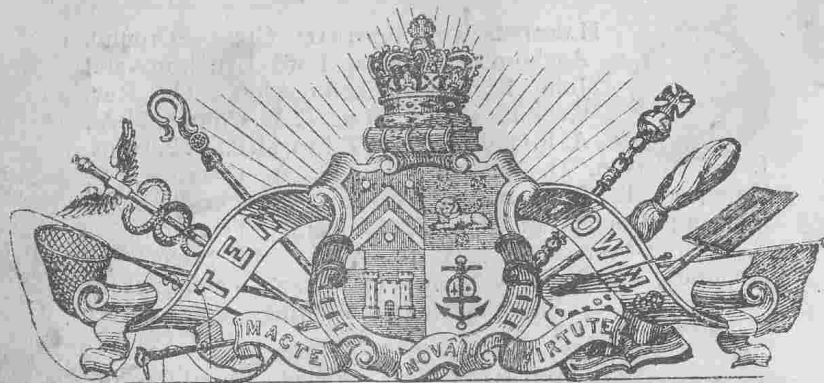

## The Local Press—Past and Present.

THE first Newspaper printed in Kidderminster appeared in the year 1838, under the title of

### The Ten Towns' Messenger,

Birmingham Times and Worcestershire, Staffordshire, and Shropshire Gazette.

It was a four-page paper of large size—twenty-eight columns—and was printed by Mr. Brough at the corner of Church Street, on the premises occupied for many years by the late Mr. James Osborne, tailor, (next the present County Court Offices); was removed to Mill Street to a factory which stood on the site of Messrs. Naylor and Lloyd's Works; from there was transferred to the Bull Ring, and printed by Mr. George Friend. It was discontinued in 1857. The above engraving is from the centre of the original heading and no doubt will be at once recognized.

After the discontinuance of the above paper, Kidderminster had to rely on the *Advertiser* (published at Brierley Hill, by Mr. Ford) for all local reports. This paper had an extensive circulation here for some years.

### The Kidderminster Times

WAS established in 1861. It is composed of fifty-six long columns; is neutral in politics, and being independent of party or sect, is extensively read by all classes. Published at 86 Coventry Street, Kidderminster, on Friday evening, price 1½d., and is printed by MR. GEORGE WILLIAMS, the Proprietor, at High Street, Worcester.

## The Kidderminster Shuttle.

THIS is the oldest existing Weekly Newspaper printed in Kidderminster. It was commenced on February 12th, 1870, by MR. EDWARD PARRY, and has been in existence twenty years under the same Editor and Proprietor. In politics it is Liberal. The *Shuttle* is an eight-page Paper of 48 columns; is the recognized organ of the English Carpet Trade, and circulates wherever Carpets are made at home and abroad. This Paper was enlarged in February, 1884, and the sub-title *Worcestershire Mercury* added. Published on Friday afternoon, price One Penny. Printing Offices, Mill Street, Kidderminster.

## The Kidderminster Sun.

WITH which is incorporated *The Ten Towns' Messenger*, was established by Messrs. Tovey and Elgood (Successors to Mr. Friend) and first printed in the Bull Ring, January, 1876. It is an eight-paged Paper of 48 columns; is the recognized Conservative organ for the district; gives full reports of local events, and is printed by MR. JOSEPH MEARS, the Proprietor, at Trinity Lane, Kidderminster. Published Weekly, on Friday for Saturday, price One Penny.

The London Daily Papers arrive at 10 a.m., and the several half-penny editions of the *Birmingham Daily Times*, *Worcester Daily Times*, and other Papers are to be had throughout the day.

## Educational—Private Schools.

KIDDERMINSTER HIGH SCHOOL FOR GIRLS, LIMITED (late Needwood House)—Head Mistress, Miss Bennett. Kindergarten Class for Boys and Girls under eight years of age.

BEECHFIELD SCHOOL FOR BOYS, near Kidderminster (late Needwood House School)—Principal, Dr. Austin.

RUSHMORE HOUSE SCHOOL FOR GIRLS, BLAKEBROOK. Principals, The Misses Friend. Pupils prepared for the Cambridge Local Examinations.

FRANCHE SCHOOL FOR GIRLS—Principal, Miss Gregg. Pupils prepared for the Cambridge Local Examinations.

BLAKEBROOK SCHOOL FOR GIRLS—Principal, Miss Ridley. Elementary and Advanced Subjects.

FARFIELD SCHOOL FOR GIRLS—Principals, The Misses Minife. Classes are held on Wednesday afternoons for instruction in Oil Painting, Water-colour Drawing, &c.

MIDDLE SCHOOL FOR GIRLS, CHELMARSH, BIRMINGHAM ROAD—Principal, Miss Buck, M.C.P. (late Mrs. Simpson) Certificated in Advanced Science and Art. Periodical Examinations. Kindergarten Class for Juniors.

CHESTER ROAD, near Oakland—Mrs. and Miss Devereux. Mixed School—Pupils taken at any time.

FRENCH—Miss Cooper, 60 Comberton Hill, receives Pupils singly or in classes.

MUSIC—Trinity College, London (Instituted 1872) Examinations for granting Certificates and Diplomas in Music. Secretary to the Kidderminster Centre, Mr. W. E. Wadely, F.C.O., Blakebrook.

BLAKEBROOK—Mrs. Parkes's Mixed School.

BEWDLEY STREET—Miss Grierson's Mixed School.

ST. GEORGE'S TERRACE—Mrs. Faimer's Mixed School.

LEA STREET—Mrs. Budd's Mixed School.

### Public Schools.

GRAMMAR SCHOOL OF KING CHARLES I (Bewdley St.): Head Master, Rev. John R. Burton, B.A., with Five Assistant Masters (for list of Governors see page 48).

WOLVERLEY GRAMMAR SCHOOL: Head Master, John Elliot, B.A., with Two Assistant Masters.

ST MARY'S SCHOOLS: Boys—(St. Mary's Street) Head Master, Mr. G. Thompson; Girls—(Churchfields) Mistress, Miss C. M. Bailey; Infants (Broad Street) Mistress, Miss M. Westwood.

ST. GEORGE'S SCHOOLS, GEORGE STREET: Boys—Head Master, Mr. F. Norman; Girls—Mistress, Miss M. Simpson; Infants—Mistress, Miss P. Jones.

WORCESTER CROSS MIXED SCHOOL (Branch of St. George's)—Mistress, Miss Harrison.

ST. JOHN'S SCHOOLS: Boys (St. John's Street)—Head Master, Mr. Neal; Girls—(Brook Street), Mistress, Miss Gardner; Infants—(Chapel Street) Mistress, Miss E. Taylor.

HOLY TRINITY, TRIMPLEY, MIXED SCHOOL—Mistress, Miss BRADLEY.

ST. BARNABAS'S, FRANCHE, MIXED SCHOOL—Mistress, Miss Grant.

ROMAN CATHOLIC SCHOOLS, LESWELL—under the Superintendence of the Sisters of St. Paul.

NEW MEETING SCHOOLS, CHURCH STREET: Boys—Head Master, Mr. W. H. Hodgson, B.A.; Girls—Mistress, Miss Ellis.

BOARD SCHOOLS—

COVENTRY STREET: Boys—Head Master, Mr. H. Beeley; Half timers, Mr. A. Evans. Girls—Mistress, Miss S. Gledhill; Half timers, Miss E. Dobson. Infants—Mistress, Miss C. J. Lanning.

HUME STREET: (MIXED)—Mistress, Miss S. A. Pardoe; Infants—Mistress, Miss E. Gwillam.

LEA STREET, BOYS—Head Master, Mr. Geo. Davies; Girls—Mistress, Miss L. Bradley. Infants, Miss T. Hillien. Infants, Miss Hillien.

MILL LANE, BOYS—Head Master, Mr. J. T. Allsop; Girls—Mistress, Miss C. Edgington; Infants, Mistress, Miss E. H. Thomas.

### Residents.

#### A

Adam William, Elderslie  
Adam Peter, Linden avenue  
Adam William, jun., Linden avenue  
Adams Major, 14 Blakebrook  
Addenbrooke E. H., 38 Millst  
Allcock Mrs., 2 Proud cross

Allcock T. L., 18 Bewdley rd  
Allsop J. T., Franche cottage  
Franche  
Anderson W. H., (J.P.) The Firs  
Andrews Mrs., 51 Bewdley street  
Ashcroft James, Bewdley hill  
Austin, Dr., Beechfield, Haberley rd.  
Austin Edward, Chester road



**Residents—continued.**

Austin H. G., 48 Bewdley st  
Awdry W. C., Bank Buildings

**B**

Bach John, High Habberley  
Bacon Hy., Chester road  
Badland Charles, Shortheath  
Baldwin Enoch, Mitton House  
Stourport  
Baldwin Alfred, Wilden  
House, Stourport  
Bagaley E. D., Birmingham rd  
Bailey Mr., Lorne street  
Bailey Miss C. M. 123 Offmore rd  
Baker W. Leswell  
Baker Fred, 9 Shrubbery st  
Banks Thomas (J.P.) 58 Leswell  
Banks G., Yew tree road  
Bannister Charles, Hurcott  
Bannister W. J., Comberton  
road  
Barker John, Shrubbery st.  
Barlow John, Woodfield  
Crescent  
Bartleet Rev. E. J. (B.A.) Com-  
berton rd.  
Barton Everard, Summer-  
dyne, Bewdley  
Barton Charles, The Shrub-  
bery, Hartlebury  
Batten C. A. C., Church st.  
Bawden J. F., 32 Leswell  
Bayley Geo., 52 Chester rd  
Beaber H., Shrubbery st  
Beach John, Chester rd.  
Beach Benj., Chester rd.  
Bedford E., 102 Lea street  
Bedford Mrs., Turton street  
Beeley H., Shrubbery street  
Bell Henry, Turton street

Bennett Hy., Cherry orchard  
Bennett Miss Needwood house  
Bennett Thos. Hoo rd.  
Bennett Edwin, 46 Farfield  
Bennie John, Oak Grove  
Beresford Edmund, Greenhill  
Bickerstaff Rev. Marcus John  
Cookley  
Bickmore Rev. F. W., The  
Vicarage, Stone  
Binnian James, Blakebrook,  
Binnian Thos. W., Mill st  
Bird E., Orchard street  
Blagborough J. Comberton rd  
Blanchford Rev. F. Henry,  
Comberton road  
Bland Joseph, Leswell  
Blundell F. L., 4 Blakebrook  
Blunt Thomas, Chester road  
Boese F. Torton, Hartlebury  
Bouet E. A., Comberton rd  
Boucher Mrs., Hillfields,  
Wolverley  
Boycott W. (J.P.) Habberley  
road  
Briggs Thomas, Winterfold,  
Chaddesley Corbett  
Brinton John (J.P.), Moor  
Hall, Stourport  
Broadfield Mrs. Blakebrook  
Broadfield H. E. Blakebrook  
Brooke T., Lorne street  
Broom F. Lea, Hartlebury  
Broome Edward Alfred, Arley  
House, Stourport  
Brown W., Bewdley hill  
Brown-Westhead Marcus,  
Lea Castle, Wolverley  
Browett Thos. B., Chester rd.  
Bucknall Mrs., Franche court  
Buck Miss, Birmingham rd

**Residents—continued.**

Bucknall T. S. Bewdley hill  
Burcher Frederick, Haw-  
thorne Villa, Shortheath  
Burton Rev. J. R., Wood-  
field house  
Butcher A., Bewdley road

**C**

Campbell D., Habberley rd  
Carter Henry, 53 Lorne st  
Carter H. G. Chester road  
Caswell Miss, 24 Shrubbery st  
Chadwick R., Mason rd  
Chadwick Wm., Blakebrook  
Chamberlain W. Marlpool lane  
Chambers James, Hall st.  
Charnock Henry, Sutton rd  
Chaytor H. J., Comberton rd  
Cheshire G. T., Shrubbery st  
Cheshire Rev. J. L., Wribben-  
hall  
Church Rev. T. W. (M.A.)  
St. George's Vicarage  
Clark Henry, Lorne street  
Coates James, Roden avenue  
Cole Moses, Farfield House  
Coley William, Chester road  
Colsey William, 30 Sutton rd  
Colsey Frank, 32 Sutton rd  
Comber Arthur, Chester rd  
Consterdine-Chadwick John  
William, Chester road  
Cooke J. R., Stourport  
Cooke Joseph Arthur, Belling-  
ton, Chaddesley Corbett  
Cope Mrs. T., Roden avenue  
Cooper J., Chester road  
Cooper E., High Bank, Mill st  
Cooper Miss, Comberton hill  
Cooper John, Hurcott road

Copeland A., Chester road  
Corbet Dr. Church st.  
Corbett Edward, Chaddesley  
Corbett  
Corbett William, Goldness,  
Hartlebury  
Corbet M., Swan st  
Cotching C. W., Habberley  
Cotton Alfred, Comberton rd  
Cowell Albert, Mason road  
Cowell Fredk., 65 Chester rd  
Cox Charles, Bewdley hill  
Coxon W. (J.P.) Blackwell st  
Coxon Thos., Hurcott road  
Crabtree Mrs., 23 Shrubbery  
street  
Crabtree John, Chester road  
Crane Mrs., The Cedars  
Cross Harry Alban, Chester rd  
Crowther William Alfred,  
The Spennells  
Crowther C., Greenhill  
Crump Rev. S., Sutton road

**D**

Dalley Clement, Brook st  
Dawe Rbt. A. H., Chester rd  
Dawes Mrs., Bewdley rd  
Dawes David, Cookley  
Deacon W., St. George's terr.  
Devereux Mrs., Chester rd  
Dixon Henry, (J.P.) Wribben-  
hall  
Dixon H. J., 11 Blakebrook  
Dougall A., 8 Blakebrook  
Doughty Thos., Vicar street  
Dow Alexander, Vicar st  
Dudley, Countess of, Witley  
Court  
Dudley, Earl of, Witley  
Court  
Dudley Wm., Lark hill

**Residents—continued.****E**

Eaddy Edward, Bewdley st  
 Earle John, 1 Habberley st  
 Elgood Joseph, Hartlebury  
 Ellis Miss, 123 Offmore road  
 Elkington Frederick (J.P.)  
 Sion Hill, Wolverley  
 Evans Dr. P., 22 Church st

**F**

Fawcett F. B., Comberton rd  
 Fawcett Henry, Comberton  
 Fawcett S. (J.P.) 1 Proud Cross  
 Fawkes W., Birmingham rd  
 Ferguson Rev. E. A., Summer  
 row  
 Ferrie Andrew, 110 Chester rd  
 Fitzgerald James, Leswell  
 Fisk Rev. Thomas, St.  
 George's terrace  
 Finch Rev., The Monks,  
 Chaddesley Corbett  
 Findon Mrs. Comberton hill  
 Foster E., Bull ring  
 France James, 49 Park lane  
 Friend Geo. Blakebrook  
 Friend The Misses, Blakebrook  
 Fuidge Rev. W. C., Lea st.  
 Furnival Rev. C. A. (B.A.) St.  
 John's Vicarage

**G**

Gale C. H., Bewdley st  
 Garrett Jos. H., Spirit lane  
 Gethin H. W., Farfield  
 Gething J. M., 34 Lark hill  
 Gibson H., Balmoral House  
 Gibson Dr. W. W., Lion st.  
 Giles John (J.P.) Bradford,  
 Hartlebury

Godson A. Frederick (M.P.),  
 Wolverley  
 Goodwin Daniel Wagstaff  
 (J.P.) The Elms, Blakebrook  
 Goodwin Daniel Parkes,  
 Oakden Villa  
 Goodwin J. R., 21, Blakebrook  
 Grant Charles, Roden avenue  
 Grant J., The Hill, Broadwaters  
 Gregg Miss, Franche  
 Green Mrs. The Copse  
 Green W. H., Roseland Villa  
 Blakebrook  
 Green William Clement (J.P.)  
 Park Attwood, Bewdley  
 Green G. R., Summerville  
 Green Mrs., Lloran lodge,  
 Proud cross  
 Greenwood T., Wolverley  
 Greenwood J., Chester road  
 Grose T. J., Birmingham rd  
 Grosvenor Geo. William (D.L.)  
 Broome Hall, nr Stourbridge  
 Grote F., 114, Chester rd  
 Grove R., New rd  
 Grove R., jun., Chester terr.  
 Chester road  
 Guest Ebenezer, Leswell

**H**

Hall Rev. J., Shrubbery st.  
 Hammond E., Franche rd  
 Hampton Isaac, Farfield  
 Hampton W., Chester road  
 Hancocks A. J., Woodfield  
 House, Wolverley  
 Hancocks William, Blakes-  
 hall House, Wolverley  
 Haigh Geo., Lorne street  
 Hancocks Miss Emily, The  
 Birches, Wolverley

**Residents—continued.**

Hancocks Major (J.P.) Wol-  
 verley Court  
 Hardiman Thomas, 2 Farfield  
 Hardiman George James,  
 Linden avenue  
 Hartland Wm. Hoarstone,  
 Bewdley  
 Harrison Mrs., Oxford st  
 Harrison G. K., Arley court,  
 Stourport  
 Harvey Chas. Coventry st  
 Harvey Josiah Peart, Short-  
 heath  
 Harvey J. Comberton  
 Harvey James J. (J.P.) The  
 Grove, Blakebrook  
 Hatton William, Hill Grove  
 Hatton Miss, Shrubbery st  
 Heath John, Coventry street  
 Hepworth Wm., Turton st  
 Hepworth B., Comberton  
 terrace  
 Herring Henry, 8 Lorne st  
 Herrin Henry, Chester road  
 Hibberd James, 99 Lea st  
 Hibberd James, junr., 11  
 Shrubbery street  
 Hibberd Henry, 13 Shrubbery  
 street  
 Higgs C., Blakebrook  
 Hillman Mrs., Leswell  
 Hobbs Capt., Hillfields,  
 Wolverley  
 Hodgson W. H., (B.A.)  
 Shrubbery st.  
 Holdsworth George, Spring-  
 field House  
 Holland J. B., 48 Farfield  
 Hollis Geo., 119 Chester road  
 Holmes J., Birmingham road

Holloway A. C., Farfield  
 Holloway Geo., 43 Farfield  
 Homfray Alfred, Broadwaters  
 Homfray H. J., Birmingham rd  
 Hooper, Wm., Birmingham rd  
 Hope T. H., Blakebrook  
 Hopkins Geo., Mill street  
 Horsfall William, 40 Wood-  
 field crescent  
 Horton W. H. 109 Chester rd  
 Horton T. H., Franche rd  
 Howard Henry (J.P.) Stone  
 House  
 Hughes Charles, Habberley  
 Hughes Wm. J., Wolverley  
 Hughes T. W., Lorne st.  
 Hughes Edward, Habberley  
 Hughes Frederick, Trimpey  
 Hughes John E., Chester rd  
 Hume Arthur, 32 Lark hill  
 Hume Henry, Findon street  
 Humphries Mrs., Coventry st  
 Humphreys John Andrew,  
 High Bank House, Mill st  
 Humphries John, Blakebrook  
 House  
 Humphries W., Shorth Heath  
 Humphries S., Blakebrook  
 Hunt S. P., Chester road  
 Hunt T. V., Offmore road  
 Hussey John S., Fernleigh,  
 Shrubbery st.  
**I**  
 Inston Samuel, Habberley  
 Isaacs Charles, Blakebrook  
 Ivens T. F., Comberton road  
**J**  
 Jackson W., Vicar street  
 James Thomas, Mill street  
 Jerome John, Lea st.  
 Jobson H. C., Summer hill

**Residents—continued.**

Johnson James, Coventry st  
 Johnson James Trenfield, 17  
 Chester road  
 Jones John J., 44 Chester rd  
 Jones Miss P., Chester terr.  
 Chester road

Jotham Miss, Elderfield  
 Jotham Frederick Charles,  
 Chester road  
 Jotham, G. W., George st

**K**

Kempson M., Shortheath  
 Kershaw Rev. John Fredk.  
 (M.A.) St. John's Vicarage,  
 Blakebrook  
 Killingbeck J., 31 Lark hill  
 Kingman G., Bewdley road  
 Knight Sir Fredk. Winn (J.P.)  
 Wolverley House  
 Knowles Mrs. J., 101 Lea st.

**L**

Lane David, High street  
 Lane Geo., 23 Lea street  
 Larr Frederic, Blakebrook  
 Larr Harry, Leswell  
 Lawley W., Comberton rd  
 Lawley Charles, Dunclent  
 Lawrence J. T., Lower Park,  
 Bewdley  
 Laycock S. W., Chester rd  
 Lea The Misses, Franche rd  
 Lea T., M.P., The Larches  
 Leech W., Birmingham road  
 Lees G., Woodfield crescent  
 Lees Mrs., Blakebrook  
 Lewis John, Park lane  
 Lister Mrs., Hurcott road  
 Lister Henry, 55 Chester road

Lloyd John, Comberton rd  
 Lloyd Robert, Offmore  
 Lloyd Sampson Zachary,  
 Arley Hall, Stourport  
 Lowe C., Bewdley street  
 Loynes S. H., 105 Chester rd

**M**

Mackay Daniel, Franche  
 Manby Cordy, Wareshill,  
 Mansell Thomas, Blackstone,  
 Bewdley  
 Mark Thomas, The Lowe,  
 Wolverley  
 Mayers, J. B., Comberton  
 Mayne A., Oakland  
 Marshall A. A., Shrubbery st  
 Maylott Owen, Leswell  
 Mayne Mrs., Oakland  
 Mears Joseph, Hurcott road  
 McCandless T., Church st  
 McBean A., Comberton road  
 Meredith Joseph Thomas,  
 Comberton road  
 Meredith Miss, Comberton rd  
 Meredith Joseph, Comberton  
 Minifie The Misses, Farfield  
 Moore William Henry, The  
 Shrubbery  
 Moore Mrs., Birmingham rd  
 Moore Dr., Mill street  
 Moore Rev. O. A., (B.A.)  
 Summer row  
 Morgan B., Habberley rd  
 Morgan Frederick Henry,  
 Comberton road  
 Morrison P., Bewdley st  
 Morton Edward James (J.P.)  
 Heathfield, Wolverley  
 Morton James, 23 Blakebrook  
 Morton J. Amphlett, Puxton

**Residents—continued.**

Mossop John, 32 Bewdley st  
 Moule R., Chester road  
 Mountford J., Roden avenue

**N**

Naylor T. F., Chester road  
 Naylor George Whitfield,  
 Lea Bank House  
 Naylor Arthur, The Lea  
 Newcomb Henry M., Bir-  
 mingham road  
 Newcomb Rev. C. E., Bir-  
 mingham road  
 Newcomb Miss, Franche road  
 Nicholls John, Leswell  
 Nicholls Jos., 24 Blakebrook  
 Nickson J. M., Habberley rd  
 Norman F., George street  
 Nutter A., Comberton terr

**O**

Oldland George Weight,  
 Morningside Lodge  
 Outram Rev. L. H., (B.A.)  
 St. John's Vicarage

**P**

Packwood Henry, Park lane  
 Page Mrs. Catherine, Broad-  
 waters Heath  
 Palmer S. B., Broadwaters  
 Palmer Mrs., 45 Lorne st  
 Park J. H., Stourport road  
 Parry Edward, Franche road  
 Paton William, Linden  
 Avenue  
 Payne Mrs., Chester road  
 Pearse J. H., Bewdley rd  
 Pearson J. E., Bewdley st  
 Penny William, 30 Church st  
 Penney James, Spring Bank

Pensotti C., Bull ring  
 Pensotti T. Comberton terrace  
 Perkins F., Chester road  
 Perkes Henry, Lea street  
 Phillips Rev. Sydney, (M.A.)  
 The Vicarage  
 Phillips Mrs., The Infirmary  
 Phillips John Julius Charles,  
 50 Bewdley st  
 Pigot Henry Beecher, Burgage  
 Lodge  
 Pigott Rev., Farfield  
 Piper Miss Jane, Wolverley  
 Piper Mary Ann, Blakenhall,  
 Wolverley  
 Plum F. D., Proud Cross  
 Poole A. W., Morningside  
 Potter E., Comberton road  
 Preen George, Marlpool lane  
 Preen Harvey Edward, Alpine  
 Villa, George st  
 Preston Dr., Mill street  
 Pritchard J., Coventry st  
 Pritchard L.S., Stourbridge rd  
 Purdey W. B., Birmingham  
 road  
 Pugh Albert, Yew tree road

**R**

Rabone Thos, 43 Chester rd  
 Randall Thomas, Shenstone  
 Ray W., Lorne street  
 Ridley Miss, Blakebrook  
 Riordan Rev. C., Leswell  
 Robinson E., Birmingham rd.  
 Roche George, Comberton rd  
 Roden Wm., Mason, Arley  
 Roden W. H., Comberton rd  
 Rowland Rev. Charles Brown,  
 Wolverley  
 Royle Mrs. Cleo Hall, Cookley

**Residents—continued.****S**

Saunders J. F. H., Comberton road  
 Saunders Miss, Franche  
 Seeley Mrs., 25 Shrubbery st  
 Scholes John, Lorne street  
 Shann Geo. V., Franche  
 Shaw Edwin, Franche road  
 Shaw Edwin, Winterdyne, Bewdley  
 Shaw G., Franche  
 Shillitoe A. J., Birmingham rd  
 Shillito Rev. W. F. (B.A.) Comberton road  
 Simpson J., Worcester cross  
 Skinner A., 62 Farfield  
 Smith H., Linden avenue  
 Smith Wm. Henry, Hagley  
 Smith Edward, The Lakes  
 Smith C. H., Park lane  
 Smith Fred., Roden avenue  
 Smith H. E., 18 Chester road  
 Smith Horatio, Franche rd  
 Spencer William Francis, Spring Grove, Bewdley  
 Spencer Rev. R. E., Church street  
 Starr Joseph, 62 Coventry st  
 Steward J. T., 1 Church st.  
 Stone J. Edward, Land Oak  
 Stone T., 113 Chester rd  
 Stretton S., (J.P.), Sunnyside  
 Stretton J. Lionel, Church st  
 Stringer H. Comberton road  
 Strudwick F., 11 Summer row  
 Sunderland B., 53 Chester rd.

**T**

Talbot George Lionel, The Lowe, Wolverley

Talbot Wm. H., Whitville  
 Tidman John, Lorne street  
 Taylor George, Bracebridge House  
 Taylor W., Church street  
 Telford Mr., 49 Chester rd  
 Tempest-Radford T. (J.P.) Beveré Manor, nr Worcester  
 Tench Wm., Shrubbery st  
 Tench Frank, Oxford street  
 Thatcher J, Linden avenue  
 Thompson R., Park lane  
 Thompson Geo., 47 Lorne street  
 Thursfield Alfred Spencer, Shortheath  
 Timmis Thomas, Stone court  
 Timmis Samuel, Shenstone  
 Tomkinson M., Franche Hall  
 Tomkinson John, Franche  
 Tucker W., Franche rd  
 Turley J. H., Shrubbery st  
 Turner Mrs., Comberton rd  
 Turton Mrs. W. Church st  
 Turton Mrs., The Castle, New road

**W**

Wakeman-Newport H. D. (J.P.) Bewdley  
 Waddell Dr., Lion street  
 Wadely W.E., 12 Blakebrook  
 Wallis Thos., Findon st  
 Wankling Mrs., Hurcott road  
 Ward, Mrs., Lea street  
 Waite M., 47 Farfield  
 Watkins A., Oxford st  
 Watson John, Waresley, Hartlebury  
 Watson J. Harold, Wolverley  
 Watson Richard Talbot, Honeybrook

**Residents—continued.**

Webster James, Franche rd  
 Welch John, Spirit lane  
 Wheatley Rev. C. A., Leswell Whitehouse Ernest Frederick Chester road  
 White Samuel, The Hoo  
 White T., Comberton terrace  
 Whitelegge Mrs. Emma, Manor House, Wolverley  
 Whittall Arthur, Proud Cross  
 Whittall George Matthew, Wribbenhall, Bewdley  
 Whittaker E. Roden avenue  
 Whitfield Chas., High street  
 Wildsmith J. T., 7 Summer row  
 Williams R., Stourbridge rd  
 Williams J., 54 Chester rd  
 Willis Henry Richard, Brockencote hall, Chaddesley Corbett  
 Willis Mrs., Shrubbery st  
 Willis, Mrs. H., Farfield  
 Wilkes Mrs. J. Chester rd.  
 Wilkes Henry, Swan street  
 Winbury W., Lorne street  
 Winbury A., Shrubbery street  
 Winbury Wm., Shrubbery st  
 Winbury C., Park lane  
 Wilson Mary, Hodge Hill  
 Wise Mrs., Birmingham rd  
 Wise Richard, Birmingham rd  
 Woodward Mrs. H. T., Fern Villa, Chester rd  
 Woodward B., Shortheath  
 Woodward R., Blakebrook  
 Woodward G., Church street  
 Woodward R. (J.P.) Arley Castle  
 Wright S., Greenhill Farm

No. of Residents } 476.

**Account Book Makers.**

Hepworth Wm., Bull ring  
 Mark T., High street

**Accountants.**

Chambers James, 2 Hall st  
 Preen H. E. & Co., Oxford st

**Agents (Commission.)**

Blagbrough J., Leswell lane  
 Blundell F. L., Vicar st  
 Chadwick Wm., Coventry st  
 Corbett, 11 Church st  
 Crabtree A., Church st  
 Fawcett F. B., Comberton rd  
 Inston S. & Son, Commercial Buildings  
 Larr Frederic, 127 Mill st  
 Pearson J. E., 11 Church st  
 Penny Henry, Swan st  
 Perkins Frederick, Mill st  
 Preen H. E. & Co., Oxford Chambers  
 Saunders J. F. H., Swan st  
 Shillitoe A. J., Orchard st  
 Stone J. E. & Co., Exchange street  
 Talbot G. Lionel, Orchard st  
 Wilkes W. H., 47 Chester rd

**Architects.**

Downton C. A., Coventry st  
 Gething Josiah M., Oxford st  
 Meredith J. T., Bank Buildings  
 Mossop John, Commercial Buildings  
 Payton G., Comberton road

**Auctioneers.**

Evans & Jackson, (late Elgood) Exchange st



**Auctioneers—continued.**

Holloway G., 32 Worcester st  
 Joseland Charles, Queen's  
 Chambers, High st.  
 Mossop John, Commercial  
 Buildings  
 Nicholls John, Commercial  
 Buildings

**Bakers.**

Broom Mrs., 49 Lea st  
 Bytheway J., Comberton hill  
 Chamberlain W., 4 Mill st  
 Copeland A., 6 Worcester st  
 and Chester road  
 Cox Mrs., 21 Lion st  
 Edwards J., 97 Blackwell st  
 Fawke John, 140 Mill st  
 Fehrenbach J., 3 Coventry st  
 Glover George, 1 Horsefair  
 Hunt Thomas, 54 Lorne st.  
 Lees Mrs., 67 New road  
 Maddocks G., 38 S. John st  
 Monday E. S., Birmingham rd  
 Nicholls W. R., 91 Bewdley st  
 Peacock A., 16 Stourbridge st  
 Pierce B., 67 Hurcott st  
 Randall William Henry, 79  
 George st  
 Ray Alfred, 5 Wood st  
 Rollings Alfred, 72 Lorne st  
 Sherwood Joseph, Park st  
 Simpson J., 57 Worcester st  
 Smith Charles, 27 Horsefair  
 Smith F. J., Bewdley st  
 Ray Joseph, 26 Mill st  
 Yates Daniel, Mill st

**Basket Makers.**

Cheaney E., 5 New road  
 Spragg W., 17 Worcester st

**Billposters.**

Longmore A., 70 Dudley st  
 Poole & Son, 32, Anchor  
 fields

**Blacksmiths.**

Rogers Richard, Bridge st.  
 Salter Thomas, Dudley st  
 Smith Mrs., Park lane  
 Ward Henry, Broadwaters

**Booksellers.**

Cheshire G. T., Vicar st  
 Hepworth W., 7 Bull Ring  
 Jenkins Reuben, 15 Mill st  
 Mark Thomas, 23 High st  
 Steward Mrs., Oxford st

**Boot and Shoe Makers.**

Barker William, 7 Mill st  
 Bell H. M., 90 Worcester st  
 Blunt Thomas, 8 Bull ring  
 Freeman, Hardy, & Willis,  
 High st and Mill st  
 French Joseph, 33 Horsefair  
 Harding Mrs., 9 Oxford st  
 Hodges J., 95 Blackwell st  
 Morris E., 29 Blackwell st  
 Morton G. & W., Swan st  
 Mound E., 107 Blackwell st  
 Richardson Thos, Blackwell  
 street  
 Saunders Joseph. Vicar st  
 Slater George, 78 Bewdley st  
 Southall Mrs., 7 High st  
 Tyler & Son, Vicar st  
 Wadeley John, 25 Park butts

**Brassfounders.**

Tench W. & Co., Church st

**Brewers.**

Bucknall T. S., Blackwell st  
 Cole M., "Worcester Cross"  
 Mumford W., "The Square  
 & Compasses," Coventry st  
 Rollings George, 25 Wood st

**Brewers' Agents.**

Hardiman T. & Co., Com-  
 berton Hill  
 Horton W. H., "Showell &  
 Sons," Old Wharf  
 Larr Harry, "Showell &  
 Sons," 63 Leswell  
 Linecar Henry, "Flowers,"  
 Comberton road  
 Wilson R., "Studley Brewery  
 Co.," Lion Square

**Brokers.**

Blent Mrs., 55 Dudley st  
 Coates William, George st  
 Cope Arthur, Park st  
 Mallard H., 51 Blackwell st  
 Millington J., 85 Worcester st  
 Oakes Mrs., 14 Churchfields  
 Stokes T., 7 Worcester st  
 Whatmore Mrs., Comberton rd

**Builders.**

Amyes John, Oxford st  
 Bale J., 99 Bromsgrove st  
 Binnian & Son, Mill st  
 Gittins A. H., St. George's terr  
 Harris Edwin, 6 Crane st  
 Howard S. & Son, Church st  
 Jones James, Coventry st  
 Lees Thomas, 44 Franchise st  
 Parker Joseph, Baxter st  
 Powell, S. Offmore road  
 Surman R., 17 Leswell terrace

**Builders—continued.**

Smith Henry, Green st  
 Thompson R. J., Park lane  
 Weaver J., 42 Churchfields  
 Wridgway W., Woodfield st  
 Vale Thomas, Lea street

**Butchers.**

Beeston S., Comberton hill  
 British and Colonial Meat  
 Supply Stores, Coventry st  
 Brown J., 124 Wood street  
 Cooke S. G., 79 Bewdley st  
 Coles George, 90 Mill street  
 Grove Elijah, 11 Park butts  
 Harris H., Comberton hill  
 Harrison Fredk., 17 High st  
 Hill Joseph, Coventry st  
 Jasper R., 56 Oxford street  
 Jasper W., Comberton hill  
 Oram Alfred, 25 Horsefair  
 Pratt John, Coventry st  
 Rastall C., Blackwell st  
 Rowley G., 4 Stourbridge st  
 Rowley George, High street  
 Smith Thos., 11 Worcester st  
 Smith F., 77 George st  
 Thomas John, 9 Blackwell st  
 Waldron Benson, 6 Mill st  
 Webster Miss, Orchard st  
 Wilkes W., Stourbridge st  
 Wilkes A., 65 Dudley st  
 Willetts James, 74 Bewdley st  
 Wood R., 92 Coventry st  
 Worrall G., 2 Blackwell st

**Cab Proprietors.**

Fawkner William, Bull ring  
 Kench John, 58 Coventry st  
 Lloyd Robert, Lion Hotel

**Cabinet Makers and Upholsterers.**

Adkins William, 19 Mill st  
Downton & Son, 70 Coventry street  
Field James, 6 Oxford st  
Howard S. & Sons, Church st  
Packwood Henry, Mill st

**Carpet Manufacturers.**

Barton J. E. & Sons, Vicar st  
Bannister William Jesse, Hartlebury road  
Bennie J & Co., Exchange st  
Brinton J. & Co., Limited, Exchange street  
Chlidema Carpet Co., Ltd., Green street  
Dixon H.J. & Sons, Limited, Dixon street  
Green W. & Sons, New road and Mill street  
Harrison C. & Son, Stourport  
Hughes E. & Sons, Mill st  
Humphries & Sons, Mill st  
Morton & Sons, New Road  
Naylor & Lloyd, Mill st  
Naylor T. & A., Green st  
Oldland G.W. & Co., New rd  
Potter & Lewis, New road  
Purdey W. B & Co., Vicar st  
\*Smith R & Sons, Mill street and Stourport  
\*Tomkinson & Adam, Church street  
Whittall M & Co., Exchange street  
Willis H. R. & Co., Oxford st  
Woodward Grosvenor & Co. Worcester street

\* Rug Manufacturers.

**Carpet Loom Gear and Reed Maker.**

Henry Perrin, 64 Coventry st

**Carpenters (Jobbing).**

Fidkin Alfred, Worcester st  
Goodwin Samuel, 7 Lorne st

**Carriers.**

Cope—"Sutton" & "Express," 14 Paradise st  
G.W.R. Parcels' Office, Marlborough street  
Jenkins—"Foster's Express" Mill street  
L.&N.W.R. Parcels' Office, Oxford street

**Chemical Manufacturers.**

Gibson Hugh & Co., Park lane  
Hepworth & Chadwick, Coventry st  
Kidderminster Chemical Co., Clensmore Works

**Chemists.**

George John, 71, Bewdley st  
Griffin J. T., High street and Comberton hill  
Morgan & Lawley, Vicar st  
Roberts Henry, 27 Mill st  
Spurway E., 2 Worcester st and Blackwell street  
Steward & Westover, Bull ring  
Willis B. W., 94 Coventry st

**Chimney Sweepers.**

Haycock George, 17 Hall st  
Poole Chas., jun., 30 Anchor fields  
Phipps W., 20 Park Butts

**Clothiers.**

Bell H. M., 5 Worcester st  
Minton W., 1 Swan st  
Purkis & Co., Coventry street (late Rayson)  
Wadhams J., 4 Worcester st  
Youngjohns Harry, Vicar st

**Second-hand Dealers.**

Ainsworth W., 1 Mill Lane  
Onions Mrs. Coventry street  
Whittaker M., Worcester st  
Youngjohns W., 84 Coventry street

**Coach Builders.**

Cruyton & Brooks, Dudley st  
Starr Joseph, 62 Coventry st

**Coal Dealers & Agents.**

Austin E., 51 Chester road  
Barratt H., 21 Park lane  
Bayley Geo., G.W. Ry. Station  
Bennett W., 6 Stourbridge st  
Bennett John, Dudley st  
Cannock Chase Coal Co., G.W. Ry. Station—Agent, B. Beach.  
Chambers J. & Son, Hall st  
Charnock H., 31 Sutton road  
Crump J. E., 76 Broad st  
Dalley C & Co., Park butts  
Downton H., junr., 17 Stourbridge st  
Evans B. G., 25 Churchfields  
Findon J. & A., Worcester st  
Holyman G. F., Bromsgrove street  
Lewis F. W., Bridge st  
Lewis Ann 41, Oxford st

**Coal Dealers—continued.**

Millward Harry, 102 Lorne st  
Munn Thomas, 26 Wood st  
Penson J. R., 4 Prospect lane  
Rogers Ann, Mill st  
Tandy Thomas 18 Cross st  
Tipper Michael, Cobden st  
Tovey William, 5 George st  
Woodward R., office, Mill st.

**Coffee Tavern.**

Worcester City & County, Vicar st

**Coffin Makers.**

Coates W., George st  
Fellows J., 41 Broadwell st  
Goodwin S., Lorne st  
Surman R., Leswell lane

**Collectors.**

Grant J., Broadwaters, Assistant Overseer, Kidderminster Foreign & Income Tax  
Grove Richard, 11 Church st, Assistant Overseer, Kidderminster Borough and Income Tax  
Guest E., Leswell, Corporation Water and General District Rates

**Confectioners.**

Abel Joseph, Bridge st  
Bishop E., 26 Blackwell st  
Brazier J., 60 Churchfields  
Chamberlain W., 4 Mill st  
Copeland A., Worcester street and Chester road  
Fehrenbach J., 3 Coventry st  
Lane D. & Co., 3 High st

**Confectioners—continued.**

Marshall F., 19 Oxford st  
Ray Joseph, 26 Mill st  
Walton Elon, 25 Comberton rd  
Yates Daniel, Mill st

**Coopers.**

Edwards T., 49 Dudley st  
Tudor Charles, 10 Mill st

**Contractor.**

Law George, 9 Comberton  
hill, North

**Cricket, Lawn Tennis,  
& Football Outfitters.**

Mark Thomas, High st  
Millward A., Comberton hill  
Steward Mrs. Oxford st.

**Dentists.**

Batten Clifford A., Church st  
Broadlick A.T., 50 Woodfield  
Crescent

Chitty E. J., 13 Bull Ring  
Roberts Henry, 27 Mill st  
Westoby S., 85 Coventry st

**Designers.**

Adkins S., Offmore road  
Beresford E., Hurcott road  
Bouet E. A., Comberton road  
Cotton Alfred, Comberton rd  
Greenwood & Perrin, 29  
Worcester st

Kingman G., Oxford Chambers  
Buildings  
Lees George, Commercial  
Buildings

Maylott Owen, Leswell  
Morrison P., Bewdley st  
Morris W., Mill street  
Rea Walter, Orchard street

**Dining-Rooms.**

Davis W., 88 Worcester st  
Garlick J., 35 Worcester st  
Lane D. & Co., High st  
Worcester City & County  
Coffee Tavern, Vicar st

**Drapers.**

Bradbury Mrs., 7 Coventry st  
Currie John, 33 Church st  
Heath Mrs., 2 High st  
Heath Mrs., 6 Comberton rd  
Holder C. F., 5 Bull Ring  
Isaacs C. Regent House High st  
Kerr Alexander, Coventry st  
Little Andrew, St. Mary's st  
McBean J. A., 46 Lorne st  
Peacock F., 21 High st  
Peacock M., Park Butts  
Perks F. (late Snell) Coventry st  
Slater George, 78 Bewdley st  
Steward Charles, 4 High st  
Tench Francis, Oxford st  
Turley & Co., 11 High st  
Weston E., 102 Blackwell st

**Dressmakers.**

Crawshaw Mrs., 39 Worcester  
street  
Grant Misses, Bull Ring  
Mills Miss, 66 Chester road  
Poyston Mrs., Horsefair

**Drysalters.**

Gibson H. & Co., Park Lane  
Hepworth & Chadwick,  
Coventry st  
Holdsworth G & Co., Callows  
lane  
Julian Claudius, Vicar street

**Drysalters—continued.**

Kidderminster Chemical Co.,  
Clenismore st  
Stone J. E. & Co., Exchange  
street  
Watson John, Church st

**Dyers.**

Cope George, Worcester st  
Nicholls T., 55 Oxford st

**Earthenware and  
China Dealers.**

Fawke John, 11 Mill st  
Lane David, Vicar st

**Emigration Agents.**

Hassell Mrs., Silver street  
Hughes T. W., Lorne st  
Nicholls John, Commercial  
Buildings

**Engineers.**

Hardcastle T., Coventry st  
Killingbeck John, Oxford st  
Knowles A., Worcester st  
Lamb John, Comberton hill

**Fancy Dealers.**

Brummitt T. R., Worcester st  
Fawke The Misses, 2 Coventry  
street  
Tattersall Eliza, 8 High st  
Wall Mrs, 5 Blackwell st

**Fellmonger.**

James Thomas, Mill st

**Fishmongers.**

Folland J., 101 Blackwell st  
Onslow W., Blackwell st  
Walford A., 111 Blackwell st  
Wheeler Miss, 20 Bull ring

**Flock Manufacturer.**

Broom Francis Lea, Mill st  
**Florists.**

Cook James, Franche  
Gardener J., Sutton road  
Shaw William, Bewdley st

**Fruiters.**

Hill J., 8 Blackwell st  
Onslow, Wm., Blackwell st  
Stone The Misses 9 High st  
Underwood T., 22 Oxford st

**Furniture Removers.**

Bennett W., Stourbridge st  
Evans B., G., Churchfields  
Jones William, 89 Park street  
Tovey William, 5 George st

**Gardeners.**

Barrett G., Offmore road  
Dyer George, 4 St. George's terr  
Gardener H. & W., Yew tree rd  
Gardener John, 28 Sutton rd  
Hilton John, Franchise street  
Moule John, Chester road  
Shaw William, Bewdley street  
Smith Samuel, 12 York street  
Webb T., 1 Woodfield cres

**Gas and Water Fitters.**

Everist Henry T., 7 Swan st  
Pannell Ed. T., 28 Horsefair  
Powell & Jennings, 90 Cov-  
entry street

**General Dealers.**

Harrison Alfred, 8 Coventry st  
Hyde William, 44 Oxford st  
Jenns Henry, 110 Blackwell st  
Tranter Francis, 1 Blackwell st  
Twigg J. W., 3 Blackwell st  
Wood Charles, 70 Bewdley st

**Green Grocers.**

Bowdler J., 75 Bewdley st  
 Harley A., 25 Coventry st  
 Hitchon John, 9 Wood street  
 Hitchon John, Mill street  
 Hitchon Mrs., 20 Coventry st  
 Onslow W., 45 Blackwell st  
 Whittall G., 72 Blackwell st  
 Underhill Richard, 20 Stour-  
 bridge street  
 Underwood T., 22 Oxford st

**Grocers and Provision Dealers.**

Allen Samuel, 22 Coventry st  
 Bagaley E. D., Bull ring  
 Baker W., 114 Blackwell st  
 Barber William, 36 South st  
 Blest John, 18 Oxford street  
 Bowyer E., 37 Worcester st  
 Boyle M., 39 Blackwell st  
 Boyle John, 69 Blackwell st  
 Bunting T., 78 Blackwell st  
 Coley S., 94 Blackwell street  
 Co-operative Stores, Oxford st  
 Horsefair and Bewdley st  
 Coxon W., 11 Blackwell st  
 Danish Dairy Co., (*Butter  
 only*) Worcester street  
 Deakin S., 63 Lea street  
 Downes M., 5 Comberton rd  
 Ewins Wm., High street  
 Fehrenbach C., Lorne street  
 Findon J. & A., Worcester st  
 and Comberton road  
 Gardener Nathan, Hurcott  
 street and Blackwell street  
 Griffiths Benj. L., 6 Swan st  
 Handley James, Mill street  
 Hunt T., 54 Lorne street  
 Mallard W. H., Blackwell st  
 Meredith Bros., 20 High st

Palmer T. H., Oxford street  
 Pearson George, 11 Mason rd  
 Preece Thomas, 10 Broad st  
 Rollings Henry, Lorne street  
 Rumsey James, Horsefair  
 Taylor and Co., Bull ring  
 Taylor H., 91 Worcester st  
 Warder W., Bewdley street  
 Ward Thomas, 73 Broad st  
 Yates John, 142 Mill street.

**Haberdashers.**

Pannell E. T., 28 Horsefair  
 Pensotti Charles, 9 Bull ring  
 Perks F. H., 5 Coventry st  
 Wiggin Mrs., 23 Mill st  
 Wood John, 18 Blackwell st

**Hairdressers**

Barker T., 29 Blackwell st  
 Bennett Henry, 3 Swan st  
 Bennett H. J., 91 Coventry st  
 Brown C., George street  
 Coates W., 53 Worcester st  
 Crane G. Green, 5 Mill st  
 Frazier F., Park butts  
 Giles Thomas, Comberton rd  
 Grimley E., Oxford street  
 Hill W. R., 12 Bromsgrove st  
 Jones Charles, 68 Bewdley st  
 Jones Charles, 18 Worcester st  
 Newey Walter, Worcester st  
 Silcox A., Park butts  
 Schwamenkrug S., 6 Bull ring  
 Smith C., Horsefair  
 Youngjohns H., 81 Dudley st

**Hatters.**

Ebury Mrs., Comberton road  
 Fletcher H., Oxford street  
 Pensotti Thomas, 1 Bull ring  
 Watkins A., Oxford st

**Hauliers.**

Bennett W., 6 Stourbridge st  
 Bennett John, Dudley st  
 Evans B. G., 25 Churchfields  
 Gardener H. & W., Yew tree rd  
 Smith James, Bewdley street  
 Tovey W., 5 George street

**Hay, Straw, and Corn Dealers.**

Bellamy John, 23 Horsefair  
 Dalley C. & Co., Park butts  
 Downton H., 17 Stourbridge st  
 Harvey J. P. & Co., Oxford  
 street and Mill street  
 Nicholls E. & C. W., 16  
 Crowther street  
 Tomkins G., 4 Lion street

**Herbalists.**

Beech B., Worcester st  
 Botanic Institute, Comberton  
 hill

**Horse Breaker.**

Earle John, Habberley street

**Horse Dealers.**

Cotching C. W., Habberley  
 Tomkins George, 4 Lion st

**Hosiers.**

Jones M. & E., 16 Blackwell st  
 Laskey Miss, 14 Bull ring

**House Agents.**

Chambers J., Hall street  
 Coxon T. B., Hurcott st  
 Guest E., Leswell  
 Nicholls J., Commercial Build-  
 ings  
 Penny J., Commercial Buildings

**Insurance Agents.**

Alliance & Royal Farmers'  
 Combined Fire, Life, and  
 Hail—  
 Thomas Milnes, "Union,"  
 Worcester street  
 Atlas Assurance Co. —  
 H. E. Broadfield, Blakebrook  
 Boiler Insurance Office—  
 J. Nicholls, Commercial  
 Buildings  
 British Empire Mutual Life  
 S. Hooper, Queen's Cham-  
 bers  
 Caledonian Fire and Life—  
 R. M. Wilkinson, 20 Oxford  
 street  
 City of Glasgow Life—  
 J. P. Harvey, 23 and 24  
 Oxford street  
 Commercial Union—  
 J. Naylor, Green street  
 H. A. Pearce, 51 Farfield st  
 H. Roberts, 27 Mill street  
 County Fire—  
 W. C. Awdry, Birmingham,  
 Dudley & District Bank  
 C. D. Badland, Shortheath  
 J. Tomkinson, Church st  
 County Hail Storm—  
 W. Penny, Birmingham  
 Banking Co., Church st  
 Economic Life—  
 J. Brinton, Exchange st.  
 J. H. Pearce, Greatfield  
 house, Bewdley hill  
 Edinburgh Life—  
 W. G. Hewitt, 35 Church st  
 Employers' Guarantee—  
 J. Nicholls, Commercial  
 Buildings



**Insurance Agents—con.**

Fire Insurance Association—  
 A. Billingsley, Worcester st  
 Harvey, Preen and Co.,  
 Oxford street.  
 R. E. P. Talbot, Honey-  
 brook house  
 General Assurance—  
 J. Caswell, 50 Oxford st  
 J. Young, 3 Brook street  
 Hand-in-Hand—  
 T. B. Coxon, Hurcott road  
 Imperial Fire Insurance Co—  
 W. Penny, Birmingham  
 Banking Co., Church st  
 M. Tomkinson, Church st  
 Insurers' Plate Glass—  
 W. G. Hewitt, 35 Church st  
 Lancashire Fire and Life—  
 A. Hopkins, 132 Mill street  
 London Guarantee and  
 Accident—  
 W. G. Hewitt, 35 Church st  
 Manchester Fire Assurance Co.  
 Fredk. Perkins, 14 Mill st  
 Mutual Accident Association  
 Limited—  
 Fredk. Perkins, 14 Mill st  
 Mutual Fire and Accident—  
 W. Paton, Linden avenue  
 Mutual Fire Insurance Cor-  
 poration, Limited—  
 Fredk. Perkins, 14 Mill st  
 New York Life Assurance Co.  
 J. Naylor, Green street  
 Northern Assurance Co.—  
 L. J. Crumpton, 47 Clarence  
 cottages, Woodfield crescent  
 J. Pritchard, Birmingham rd  
 J. F. H. Saunders, Swan st  
 T. H. Williams, 57 Lorne st

Norwich and London Acci-  
 dent and Plate Glass—  
 A. Hopkins, 132 Mill st  
 Norwich Union Fire—  
 H. Penny, 12 Swan street  
 Ocean, Railway, and General  
 Accident Assurance Co.—  
 J. Naylor, Green street  
 Phoenix Fire—  
 A. Crabtree, 9 Church st  
 C. Joseland, Queen's Cham-  
 bers, High street  
 C. Whitefield, 19 High st  
 P. Lawson, Comberton hill  
 W. G. Hewitt, 35 Church st  
 Provident Life—  
 C. D. Badland, 5 Shortheath  
 W. C. Awdry, Birmingham  
 Dudley and District Bank  
 J. Tomkinson, Church st  
 Prudential Assurance Co.—  
 District Superintendent,  
 H. Coupe, St. George's terr  
 Railway Passengers'—  
 W. Penny, Birmingham  
 Banking Co., Church st  
 Refuge Life—  
 W. Johnson, 12 Horsefair  
 Reliance Mutual Life—  
 J. Nicholls, Commercial  
 Buildings  
 Royal Exchange  
 A. Cowell, Broomfield Villa  
 Scottish Imperial Insurance—  
 G. Brown and Sons, Cov-  
 entry street  
 Scottish Provident Institution  
 W. Paton, Linden avenue  
 Standard Life Assurance Co.—  
 Fredk. Perkins, 14 Mill st

**Insurance Agents—con.**

Sun Fire Office—  
 A. Dow, 1 Vicar st  
 Temperance and General  
 Life Assurance—  
 R. M. Wilkinson, 20 Oxford  
 street  
 Westminster Fire Office—  
 H. J. Dixon, Long Meadow  
 Mills  
 W. H. Talbot, 35 Church st  
 Yorkshire Fire and Life—  
 R. E. Grove, 14 Chester rd

**Ironfounders.**

Bale Herbert, Pitt's lane  
 Bradley F., Clensmore foundry  
 Lewis John, Park lane  
 Preston E., Park lane

**Ironmongers.**

Fergrieve & Co., 7 Oxford st  
 Glasbrook N., 1 Coventry st  
 Watkins Charles, Horsefair  
 Welch John, 15 High street  
 Whitfield Charles, 19 High st  
 Wise Richard, 11 Bull ring

**Lamp and Oil Dealers.**

Curtis H., 83 Bewdley street  
 Jordan H. A., 71 Blackwell st  
 Holloway W., Park butts  
 Tunstall J., 89 Coventry st  
 Underwood E., Park lane  
 Wright H., Blackwell street  
 Wright Thos., 43 Dudley st

**Leather Sellers.**

Bradshaw W., 4 Blackwell st  
 Clee Mrs., 81 Coventry street  
 Holland J., 24 Mill street  
 Matthews W., 1 Prospect hill

**LICENSED HOUSES.  
Alehouses.**

Ainsworth E.—The Hen and  
 Chickens—Mill street  
 Arnold Joseph—The Vine—  
 Horsefair  
 Arnold W.—The Freemasons'  
 Arms—Bromsgrove street  
 Bagnall W.—The Tap House  
 Blakebrook  
 Baker Fred.—The Duke of  
 York—Churchfields  
 Baylis T.—The Roe Buck—  
 Oxford street  
 Bennett Mrs. J. L.—The Corn  
 Exchange—New Road  
 Brice W.—The Blue Bell—  
 Hurcott street  
 Brimfield J.—The Old  
 Lyttelton's Arms, Park butts  
 Broom Mrs.—The Cookley  
 Arms—Stourbridge street  
 Brown Mrs.—The Royal  
 George—Hall street  
 Butcher G.—The Lamb—  
 Bromsgrove street  
 Carter J.—The Duke of  
 Edinburgh—Bromsgrove st  
 Carter J. H.—The Old Com-  
 passes—Coventry street  
 Chadwick R.—The Naviga-  
 tion Hotel—Clensmore st  
 Clarke Wm.—The Castle—  
 Park lane  
 Coates G.—The Chester  
 Tavern—Chester road  
 Cole G.—The Pied Bull—  
 Mill street  
 Comber A.—Working Men's  
 Club—Coventry street  
 Cookson W.—The Bishop  
 Blaze—Dudley street

**Alehouses**—*continued.*

Cooper A.—The Leopard—  
Hoo lane  
Cowell Mrs.—The Alma—  
Habberley street  
Crump J. E.—The Wool  
Pack—Broad street  
Danby A.—The Raven—  
Bromsgrove street  
Darkes James—The Fox—  
Swan street  
Denning G.—The Robin  
Hood—Offmore road  
Field Mrs.—The Railway  
Station—Farfield  
Fish J.—The Old Bear—  
Stourbridge street  
Gale H.—The White Hart—  
Waterloo street  
Goodman F.—The Rose and  
Crown—Blackwell street  
Green Mrs.—The Black  
Horse—Mill street  
Green T.—The Worcester  
Cross  
Gudgeon J. C.—The Cricket-  
ers' Arms—Lorne street  
Hale W.—The Angel—Wor-  
cester street  
Hall H.—The Cape of Good  
Hope—New road  
Hardiman J. C.—The Old  
Olive Tree and Dove—  
Bewdley street  
Hardiman T.—The Bay  
Horse—Market street  
Hartwell G.—The Pheasant  
Mill street

Harvey C., Harvey J. J., and  
Jotham F. C.—The Wine  
Vaults—Coventry street  
Hearn C.—The Bell—Cov-  
entry street  
Heath E.—The Horn and  
Trumpet—Park butts  
Hetherington T. P.—The  
Bridge Inn—Mill street  
Hewitt W. G.—The George  
and Dragon—Trinity lane  
Hill H.—The Cross Keys—  
Worcester street  
Hill W.—The Half-Moon—  
New road  
Homer D. W.—The Royal  
Exchange—New road  
Hooper A.—The Unicorn—  
Churchfields  
Hopkins G.—The George—  
Mill street  
Hopkins Geo.—The Wheat  
Sheaf—Worcester street  
Hughes G. T.—The Park Gate  
Mill street  
Hughes I.—The Plough—  
Churchfields  
Jefferies A.—The Anchor—  
Worcester street  
Jefferies Joseph—The Wood-  
field Tavern—Woodfield rd  
Johnson C., the younger—  
The Grand Turk—Sutton  
road  
Jones H. A.—The Crown  
and Anchor—Jerusalem  
walk  
Kimberlee S.—The Cock—  
Horsefair  
Lench T.—The Clarendon—  
Comberton hill

**Alehouses**—*continued.*

Lloyd R.—The Lion Hotel—  
High street  
Martin F. C.—The Market  
Hall Vaults—Oxford street  
Mason J.—The Black Bull—  
Swan street  
Milnes T.—The Union—  
Worcester street  
Morhall S.—The Bottle-in-  
Hand—Dudley street  
Mumford W.—Square and  
Compass—Coventry street  
Palmer A. E.—The Peacock  
Horsefair  
Payne Joseph—The Seven  
Stars—Coventry street  
Perks J.—The Railway Bell—  
Comberton hill  
Phipps W.—The Queen's  
Head—Stourbridge street  
Pratt G.—The Red Lion—  
Mill street  
Price Thos.—Prince Albert  
Bewdley street  
Prince J.—The Royal Oak—  
South street  
Raybould H.—Refreshment  
Rooms—Railway Station  
Rogers R.—The Three Tuns'  
Vicar street  
Rollings A.—The Golden  
Lion—George street  
Rollings G.—The Sports-  
man—Wood street  
Rowley J.—The Foley Arms  
Cross street  
Silk E.—The Belle Vue—  
George street  
Smith S.—The Nelson—  
Blackwell street

Southan W.—The Bird-in-  
Hand—Queen street  
Starr F.—The Harp—Horse-  
fair  
Steight W. J. M.—The  
Weary Traveller—Sutton rd  
Taylor E.—The Dudley Arms  
Coventry street  
Taylor F.—The Star—  
Blackwell street  
Taylor T.—The Rifleman—  
Horsefair  
Taylor W.—The Coach and  
Horses—Mill street  
Teague J.—The Barley Mow  
Bewdley street  
Thomas S.—The Albion—  
Broad street  
Thomas W. D.—The Rein-  
deer—Mill street  
Tittle Mrs.—The Swan—  
Vicar street  
Tomlinson G. B.—The  
Grapes—Worcester street  
Tunington Mrs.—The New  
Inn—Stourbridge street  
Walton B.—The King's Head  
Constitution hill  
Ward T.—The Boar's Head  
Worcester street  
Webster E.—The Plough  
and Harrows—Bewdley st  
Welding G. D.—The Crown  
Worcester street  
Wheeler T.—The Sailor's  
Return—York place  
Whitmarsh I.—The Star and  
Garter—Union street  
Whittall F.—The Lion Field  
Tavern—Fair street

**Alehouses—continued.**

Whittall J. — The Fish — Orchard street  
 Wild G.—The Boat—Clensmore street  
 Willey G.—The Red Man—Blackwell street  
 Williams E.—The Land Oak—Land Oak  
 Wilson R. S. — The Rock Tavern—Bewdley street  
 Yarnall G.—The Dolphin—Worcester street

**Beerhouses, &c.**

Bullus B. — The Rampant Lion—George street  
 Bunting T.—The Waterloo Tavern—Waterloo street  
 Cook M. — The Britannia Blackwell street  
 Cookson S., the younger—The George Inn—George st  
 Crisp Thomas — The Hop Pole—Mount Pleasant  
 Glover E.—The Uncle Tom's Cabin—Park street  
 Godridge W.—The King of Prussia—Lion street  
 Green W. — The Horsefair Tavern—Stourbridge st  
 Harman W. — The Turk's Head—Worcester street  
 Jackson S.—The West Midland Railway Inn—Worcester street  
 Jenkinson G. H.—The King William—St. John street  
 Jerome J. A.,—Rising Sun—Park butts

**Beerhouses—continued.**

Kimberlee J.—Old Tumbling Sailors—Mill lane  
 Lench E.—The Black Boy—Hill street  
 Paton J.—The Railway Train Offmore road  
 Pugh J.—The Malt Shovel—Chapel street  
 Rollings Mrs. T.—The King's Arms—Bromsgrove street  
 Stephens C. — The Green Dragon, Cross street  
 Taylor W.—The Travellers' Rest—Blackwell street  
 Ward T.—(Cider)—The Sun Worcester street  
 Walton E., 25 Comberton hill  
 Wheeler J. — The Parkers' Arms—Park lane  
 Worrall G., Barnsley's hill  
 Wright J.—The Bricklayers' Arms—Blackwell street  
 Yarnall G.—The Nag's Head Sutton road

**Wines—on Premises.**

Abel J., 1 Bridge street  
 Bryan Mrs., 3 Comberton hill  
 Chamberlain W., 4 Mill st  
 Fehrenbach J.,—Coventry st  
 Lane D., 3 High street  
 Ray J., 28 Mill street  
 Walton, E., 25 Comberton hill  
 Worrall G., Barnsley's hill

**Licenses—Off Premises.**

Beams C., 10 Pleasant street  
 Cooke W., Park street  
 Cooper W., George street

**Licenses—Off Premises.**

Coley Mrs., 3 Franchise st  
 Coxon W., Blackwell street  
 Deakin S., Franklin Place, Lea street  
 Findon John and Findon Alfred, Worcester street  
 Frost J., Sutton common  
 Green A., 5 Radford avenue  
 Griffiths B. L., Swan street  
 Hardiman T., Comberton Hill Stores—Comberton hill  
 Hartley T., 50 Bewdley street  
 Meredith Joseph & Meredith James, High street  
 Merrick B., 11 Lion street  
 Mumford W., Greenhill  
 Pursey T. W., 10 Dudley st  
 Richards F., 27 Wood street  
 Rollings A. W., 72 Lorne st  
 Rollings H., Lorne street  
 Rumsey J.—The Horsefair Stores—9 Horsefair  
 Sheffield W., Peel street  
 Styles C., Foley park  
 Taylor G., 2 Bromsgrove st  
 Taylor H., Worcester street  
 Warder William—The West End Stores—Bewdley street  
 Watkins W., Clensmore st  
 Whatley A., Peel street

**Lithographer.**

Hepworth W., 7 Bull ring  
**Lodging House Keepers**  
 Avery W., 20 Paradise street  
 Brewer Mrs., 106 Blackwell st  
 Dyer A., 30 Blackwell street  
 Evans J., 29 Worcester st  
 Faramondy J., 18 Coventry st  
 Hawthorn J., 78 Coventry st  
 Wainwright J., 6 Horsefair

**Loom-Frame Maker.**

Fidkin A., Worcester st

**Maltsters.**

Cole M., Worcester cross  
 Green W. H., Blackwell street and Sutton road  
 Hampton I. & Co., Oxford st  
 Hodges C., 1 Anchor fields  
 Shepherd T., Franche

**Marine Store Dealer.**

Baker W., 114 Blackwell st

**Market Gardeners.**

Hammond J., 46 Hurcott st  
 Hill J., 30 Radford avenue  
 Morgan J. L., Habberley rd  
 Nickson J. M., Franche  
 Porter J., 42 Broad street  
 Preece T., 10 Broad street  
 Smith J. & G., 45 Lark hill  
 Wright S., Hurcott road

**Medical Practitioners.**

Addenbrook E. H., 38 Mill st  
 Corbet D., Church street  
 Evans P., Church street (late Langford)  
 Gibson W. W., Lion street (Medical Aid Association)  
 Jotham G. W., George st  
 Moore W. H., Church street (late Colbourne)  
 Preston H. T., Mill street  
 Stretton S., Church street  
 Stretton J. Lionel, Church st  
 Waddell A. R., Lion street

**Mill Furnisher.**

Killingbeck J., Oxford streer

**Millers.**

Brewster J., Heathy Mill  
Goodwin D. W. & Co., Mill st  
Harvey J. P. & Co., Mill st

**Milliners.**

Bowdler J., 14 New road  
Bury G., 22 York street  
Crawshaw Mrs., Worcester st  
Davis W., Broadwaters Mill  
Gane G., 19 Coventry street  
Grant Misses, 13 Bull ring  
Ingham J. T., 54 Oxford st  
Inkes and Morgan, Horsefair  
Jenkes and Morgan, 2 Comb-  
berton road and Horsefair  
Peacock Mark, Park butts  
Perks F. H., 5 Coventry street  
Storer C. R., Comberton rd  
Taylor A. Wellesley, 2 Bewd-  
ley street  
White Miss 13 Mill street  
Wilkinson R. M., 20 Oxford st

**Mineral Water  
Manufacturers.**

Bucknall T. S., Blackwell st  
Dunn F., 18 Radford avenue  
Hitchon John, Wood street  
Payne W., 63 Dudley st

**Music and Pianoforte  
Dealers.**

Heys J. B., Trinity lane  
Jackson W., Vicar st

**Newsagents.**

Caswell J., 50 Oxford street  
Davis T., Bromsgrove street  
Davis R., 14 Bewdley street  
Hardiman A., 18 Mill st

Rollings E., 37 Oxford street  
Smith R., 29 Horsefair  
Young C., 82 Coventry street  
Young Mrs., 102 Blackwell st

**Organists.**

Fitzgerald J., 31 Lenswell  
Taylor W., 17 Church street  
Wadely W. E., Blakebrook

**Plumbers & Painters.**

Cooksey Bros. 38 Worcester st  
Cooksey E., 34 Horsefair  
Downes G. H., 73 Bewdley st  
Heath J., 12 Coventry street  
Parker W., 1 Waterloo street  
Stevenson W., 65 Coventry st  
Thomas C. F., 73 Coventry st  
Williamson & Co., 33 Mill st  
Wright H., Blackwell st  
Wright T., 43 Dudley street

**Paint and Oil Dealer.**

Wright H., 17 Blackwell st

**Paper Maker.**

James T. & Co., Hurcott  
Mill

**Pawnbrokers.**

Findon J. & A., 23 Worcester  
street  
Hassell Mrs., 25 Silver street  
Hughes J., 15 Waterloo street  
White Mrs., 85 Dudley st  
Whittaker M. & Co., Wor-  
cester street

**Photographers.**

Ball T., 7 Comberton rd  
Bromwich J., Comberton rd  
Harrison Mrs., 51 Oxford st  
Storer C. R., Comberton rd

**Picture Framers.**

Haywood H., 23 Blackwell st  
Hodges W., 21 Worcester st

**Pork Butchers.**

Baker F., 112 Blackwell st  
Brown, G., 102 Blackwell st  
Hanglin R., 12 Bewdley st  
Lucas E., 5 Swan street  
Lucas S., 65 Blackwell Street  
Taylor H., 89 Worcester st

**Printers.**

Brooke T., Pitt's lane  
Cheshire G. T., Vicar street  
Hepworth W., 7 Bull ring  
Mark T., 23 High street  
Mears J., Trinity Lane  
Parry E., Oxford street

**Pump Makers.**

Thomas and Wilkes, New rd

**Rope Maker.**

Jelleyman F. F., 25 Mill st

**Saddlers.**

Tranter Frank, 6 Coventry st  
Wellings J., 10 Bull ring

**Seedsman.**

Dalley and Co., Park butts  
Findon J. & A., Worcester st  
Griffiths B. L., Swan street  
Harvey J. P., Oxford street  
and Mill street  
Meredith Bros., High street

**Servants' Registry.**

Fisher M., 61 Worcester st

**Sewing Machines.**

'Jones' T. Blunt, Town Bridge  
'Singer' Co., Oxford street

**Shoing Smiths.**

Rogers R., 1 Bridge street  
Rogers W., 2 Bridge street

**Shopkeepers.**

Anslov Mrs., 4 Churchfields  
Barrett G., Offmore road  
Blandford J., 111 Wood st  
Blencowe J., 54 Wood st  
Bragginton Mrs., 27 Com-  
berton road  
Bryan Mrs., 3 Comberton rd  
Bullas T. J., Wood street  
Clark W., 40 Park lane  
Cole G., 'Pied Bull,' Mill st  
Commander Mrs., 81 George st  
Cooper W., 62 George street  
Croft Mrs., Sutton common  
Deakin S., 63 Lea street  
Eldred Mrs., 1 Peel street  
Fehrenbach C., 1 Lorne street  
Finlow T., 26 Sutton road  
Green A., 9 Radford avenue  
Green Mrs., Broadwaters  
Harley T. H., 62 Mill street  
Haywood H., Sutton common  
Perks F., 96 Park street  
Pugh S. H., 11 George street  
Ratcliff D., 18 Stourbridge st  
Rhee W. S., Sutton common  
Rollings H., Lorne street  
Rudge A., 10 Sutton road  
Salter G., 65 Park street  
Smith C. T., Broadwaters  
Smith Mrs., 58 Dudley street  
Steward J., 18 Hall street  
Thomas G., 87 George st  
Uncles H. J., 21 Park butts  
Whittall Mrs., 39 Queen st  
Williams E., 54 Stourbridge st  
Youngjohns Mrs., Churchfields

**Slate Merchant.**

Gillam John, George street



**Slipper Maker.**

Jenns E., 21 Blackwell street

**Solicitors.**

Bagster Basil Birch, Court  
12 Worcester street

Burcher F., 8 Church street

Corbet M., 11 Swan street

Crowther W. A., Bank build-  
ings

Gould & Elcock, 3 Church st

Hooper S., Queen's chambers

Ivens and Morton, Bank  
buildings

Perrin Fred., Commercial  
buildings

Roden and Dawes, Bank  
buildings

Talbot W. H., and E. W.,  
Church street

Thursfield A. S., Swan street

**Spinners.**

Birkett W., New road

Brinton J. & Co., Limited,  
Exchange street

Broome E. A., New road

Lea T., The Sling

Watson Bros., Green street

**Stationers.**

Cheshire G. T., Vicar street

Hepworth W., 7 Bull ring

Mark T., 23 High street

Paton W., Comberton road

Steward Mrs., 8 Oxford street

**Stonemasons.**

Brown G. & Sons, Coventry st

Brown T. & W., Stourbridge  
street

Haigh W., Park lane

Scholes & Sons, Comberton rd

**Tailors.**

Allen H. T., Comberton road

Allen R., 12 Bull ring

Bennett T., 2 Church street

Broadhurst S., 7 Stourbridge st

Brook T., 69 New road

Co-operative Society, Wor-  
cester street

Giles F., 86 Lea street and

Bewdley street

Gill T., Prospect hill

Greenwood T., Comberton

hill

Hammond E., 14 Mill street

Isaacs G. & C., High street

McCandless T., 4 Church st

Perrin and Smith, 56 George st

Shaw W., 67 Bewdley street

Wilkes H., 10 Swan street

Williams, T., 63 George st

**Tallow Chandlers.**

Lister Henry, Waterloo st

Findon J. and A., Lion square

**Tanners.**

Withall W. C. & Co., (Exors.

of) Orchard street

**Tea Dealers.**

Cooper and Co., 2 and 3

Bull ring

King F. E., 18 Bull ring

London and Counties Tea Co.

High street

**Teachers of Music.**

Fitzgerald J., Leswell

Taylor S., 3 Stourbridge st

Taylor W., Mus. Bac., Church

street

Wadley W. E., 12 Blakebrook

**Ticket Writer.**

Muir D. W., Springfield place

Sutton road

**Timber Merchants.**

Higgs and White, New road

Lawrence J. T. and Co.,

Park lane

**Tin-plate Manufacturers**

Crowther Bros. and Co.,

Stour Vale Ironworks

**Tinmen.**

Lockley C., 12 Villiers st

Lockley Mrs., 87 Coventry st

Williams G., 8 Swan street

**Tobacconists.**

Bowyer A., Oxford street

Harrison E., 1 Comberton hill

Harrison C., Bull ring

Ingham T., Comberton hill

Johnson W., Horsefair

Jones H., 141 Mill street

Simpson C., Blackwell street

Smith T., 12 Park butts

Taylor F., 10 Oxford street

Tidman J., 15 Bull ring

Webster T., 9 Comberton hill

**Toy Dealers.**

Brummitt T. R. 76 Worcester

street

Crane G. G., 5 Mill street

Fawke Misses, Coventry st

Hardiman A., 18 Mill st

Schwamenkrudge S., Bull ring

Wall Mrs., 3 Blackwell st

**Tripe Sellers.**

Hankin J., 83 Coventry st

Jasper W., George street

Jones Mrs., Worcester street

Worrall G., Blackwell street

**Umbrella Makers.**

Lovett Wm., 42 Blackwell st

Smith W., 6 New road

**Veterinary Surgeons.**

Smith, R. J., 4 Worcester st

Wright John, 17 Mill street

**Wagonette Proprietors.**

Bennett W., 6 Stourbridge st

Fawkner W., Bull ring

Greenwood R., 8 St. George's

Terrace

Tandy T., Cross street

Tovey Wm., 5 George st

**Waste Dealers.**

Cooper Enos, Park lane

Shillitoe A. J., Orchard street

**Watchmakers.**

Boese Bernard, 24 High st

Copeland W., 6 High street

Doughty T., Vicar street

Fehrenbach G., 9 Mill street

Foster E., 17 Bull ring

Mason H., Blackwell street

Yarnold H., 17 Oxford street

**Whitewashers and****Paperhangers.**

Hughes W., Radford avenue

Potter Geo., 52 Mill lane

**Whitesmith.**

Rollings John, New road

**Wheelwrights.**

Brace S., Blackwell street

Edwards J., George street

Hall J., Broadwaters

Nicholls J., Habberley road

Salters T., 60 Dudley street

### Wine and Spirit Merchants.

Hardiman T. and Co., Com-  
berton hill

Harvey Charles & Co., Swan st

Hetherington T. P. and Co.,  
Town Bridge  
Hopkins G. and Son, Mill st

### Wireworker.

Bennett W., 35 Horsefair

## THE GUIDE.

THE Publisher, in issuing this small work, desires to bear testimony to the great interest taken in the Guide portion, and in the providing of Sketches by the late MR. BROADFIELD.

—o—

## THE DIRECTORY.

ANY Member of a Profession, or Tradesman, omitted from this Directory, will oblige by calling at the Publishing Office, Bull Ring, and placing his name and address in a Book prepared for the purpose, for future publication.

—o—

### School Board.

TRIENNIAL ELECTION—APRIL 3rd, 1889.

—o—

	<i>No. of Votes.</i>
Kershaw, Rev. J. F. (M.A.) ... ..	3366
Awdry, W. C. ... ..	2793
Parry, E. ....	2765
Phillips, Rev. S. (M.A.) ... ..	2710
Holloway, Geo. ... ..	2334
Grosvenor, G. W. ... ..	2301
Morton, E. J. (Mayor) ... ..	2178
Wheatley, Rev. C. A. ... ..	2086
Binnian, T. W. ... ..	1916